

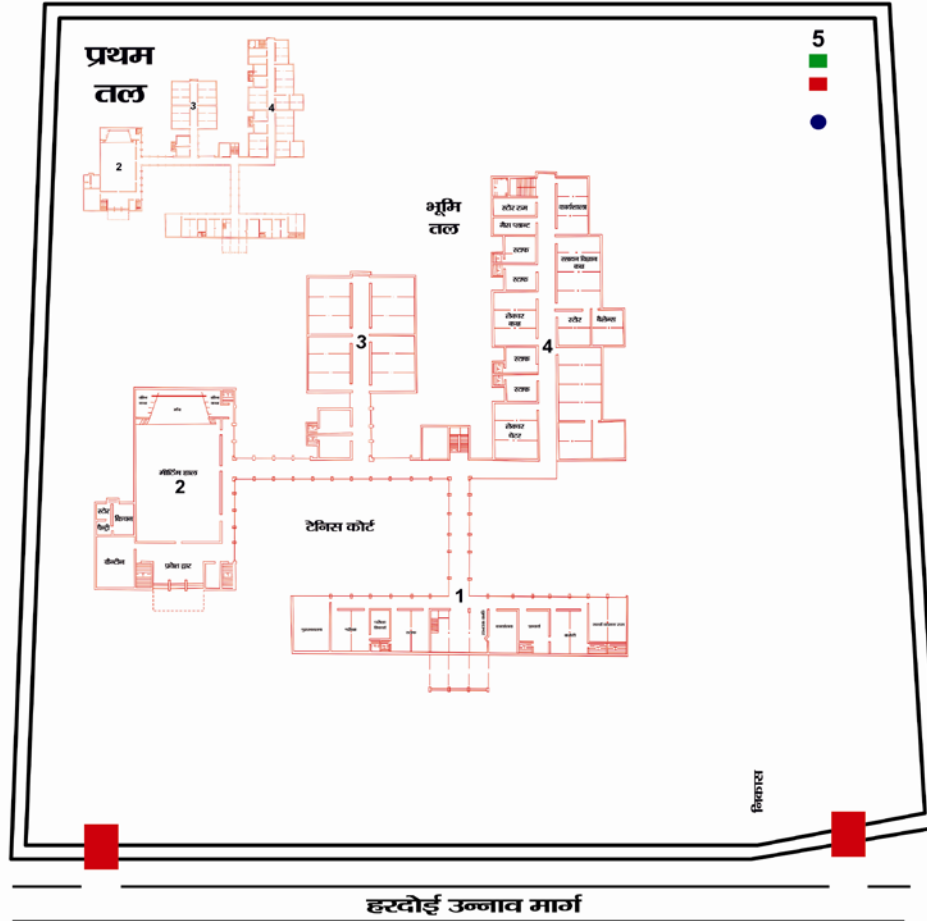

इन्दिरा गाँधी राजकीय स्नातकोत्तर महाविद्यालय

बाँगरमऊ, उन्नाव



प्रथम तल

1. प्रशासनिक भवन
2. कला संकाय
3. वाणिज्य संकाय
4. विज्ञान संकाय

भूमि तल

1. प्रशासनिक भवन
2. कला संकाय
3. वाणिज्य संकाय
4. विज्ञान संकाय
5. प्राचार्य आवास
पानी की टंकी
छात्रा वास



SITUATION OF BANGARMAU IN THE LAYOUT MAP

CONTENTS

1.	Profile of the Affiliated/ Constituent College	8-16
2.	Criteria- Wise Input	16-22
	a) Curricular Aspects	16-19
	b) Academic Flexibility	19-20
	c) Curriculum & Enrichment	20-22
	d) Feedback System	22-22
3.	Teaching – Learning & Evaluation	23-39
	a) Student Enrichment & Profile	23-29
	b) Catering to diverse need of Students	30-31
	c) Teaching Learning Process	31-33
	d) Teacher Quality	34-36
	e) Evaluation Process & Reforms	36-38
	f) Student Performance & Learning Outcomes	38-39
4.	Research, Consultancy & Extension	40-49
	a) Promotion of Research	40-41
	b) Resource Mobilization for Research	42-43
	c) Research Facilities	43-44
	d) Research Publications & Awards	44-45
	e) Consultancy	45-46
	f) Extension Activities & Institutional Social Responsibility	46-48
	g) Collaboration	48-49
5.	Infrastructure & Learning – Resources	50-58
	a) Physical Facilities	50-51
	b) Library as a Learning Resource	52-54
	c) Infrastructure	55-56
	d) Maintenance Campus facilities	56-58

6. Student Support & Progression	59-68
a) Student Mentoring & Support	59-62
b) Student Progression	62-64
c) Student Participation & Activities	64-68
7. Governance, Leadership & Management	69-77
a) Institutional Vision & Leadership	69-71
b) Strategy Development & Deployment	71-73
c) Faculty Empowerment Strategy	73-74
d) Financial Management & Resource Mobilization	74-75
e) Internal Quality Assurance System	75-77
8. Innovation & Best Practices	77-78
a) Environment Consciousness	77-77
b) Innovation	78-78
c) Best Practices	78-78
9. Evaluative Report of the Department	79-143
a) Botany	79-85
b) Zoology	86-91
c) Mathematics	92-97
d) Physics	98-102
e) History	103-107
f) Hindi	108-112
g) Physical Education	113-117
h) Economics	118-122
i) Sociology	123-127
j) Sanskrit	128-132
k) Commerce	133-143

10. Format for Presentation of Practice	144-148
a) Title of The Practice	144-144
b) Goal	144-144
c) Context	145-145
d) The Practice	145-146
e) Evidence of Success	146-147
f) Problems Encountered and Resources Required	147-147
g) Notes (Optional)	147-148
h) Contact Details	148-148

Part-II

1. Executive Summary	150-151
2. Declaration by the Head of the Institution	152-152
3. NAAC Letter	153-153
4. Certificate of	154-154
5. Permanent Affiliation of B.A & B.Com.	155-155
6. Permanent Affiliation of B.Sc.	156-156
7. Permanent Affiliation of P.G.	157-157
8. Certificate of Backward Area.	158-158

PART-I

B. Profile of the Affiliated /Constituent College

1. Name and address of the college:

Name: INDIRA GANDHI GOVT.P.G COLLEGE, BANGARMAU, UNNAO (U.P)

Address: HARDOI-UNNAO ROAD, BANGARMAU, UNNAO, (U.P)

City: BANGARMAU Pin: 209868

State: UTTAR PRADESH

Website: iggpgcbmu.org

2. For communication:

Designation	Name	Telephone with STD code	Mobile	Fax	E-mail
Principal	Dr.Rajeev Dhasmana	O: 05144-250288 R:	9415952203	05144-250288	iggpgcbmu@iggpgcbmu.org
Vice Principal	N A	O: N A R:	N A	N A	N A
Steering Committee Co-ordinator	Dr. Anil Kumar	O: R:	9450769949		anilmath.kumar@gmail.com

3. Status of the of Institution :

Affiliated College

✓

Constituent College

Any other (specify)

4. Type of Institution:

a. By Gender

i.For Men

--

ii. For Women

--

iii. Co-education

✓

b. By shift

i. Regular

--

ii. Day

✓

iii. Evening

--

5. Is it a recognized minority institution?

Yes

✓

No

If yes specify the minority status (Religious/linguistic/ any other) and provide documentary evidence.

--

6. Source of funding:

- Government
- Grant-in-aid
- Self-financing
- Any other

√

7. a. Date of establishment of the college: ...15/07/1988..... (dd/mm/yyyy)

b. University to which the college is affiliated /or which governs the college (If it is a constituent college)

C.S.J.M UNIVRSITY KANPUR (U.P)

c. Details of UGC recognition:

Under Section	Date, Month & Year (dd-mm-yyyy)	Remarks (If any)
i. 2 (f)	19-03-1994	-
ii. 12 (B)	19-03-1994	-

(Enclose the Certificate of recognition u/s 2 (f) and 12 (B) of the UGC Act)

d. Details of recognition/approval by statutory/regulatory bodies other than UGC (AICTE, NCTE, MCI, DCI, PCI, RCI etc.)

Under Section/clause	Recognition/Approval details Institution/Department/ Program	Day, Month and Year (dd-mm-yyyy)	Validity	Remarks
i.	NA	NA	NA	NA
ii.	NA	NA	NA	NA
iii.	NA	NA	NA	NA
iv.	NA	NA	NA	NA

(Enclose the recognition/approval letter)

8. Does the affiliating university Act provide for conferment of autonomy (as recognized by the UGC), on its affiliated colleges?

Yes No

If yes, has the College applied for availing the autonomous status?

Yes No

9. Is the college recognized

a. by UGC as a College with Potential for Excellence (CPE)?

Yes No

If yes, date of recognition: (dd/mm/yyyy)

b. for its performance by any other governmental agency?

Yes No

If yes, Name of the agency and

Date of recognition: (dd/mm/yyyy)

10. Location of the campus and area in sq.mts:

Location *	Rural
Campus area in sq. mts.	48562 sqm
Built up area in sq. mts.	4532sqm

(* Urban, Semi-urban, Rural, Tribal, Hilly Area, Any others specify)

11. Facilities available on the campus (Tick the available facility and provide numbers or other details at appropriate places) or in case the institute has an agreement with other agencies in using any of the listed facilities provide information on the facilities covered under the agreement.

- Auditorium/seminar complex with infrastructural facilities
 - Sports facilities
 - * play ground √
 - * swimming pool NA
 - * gymnasium √
 - Hostel
 - * Boys' hostel
 - i. Number of hostels -01
 - ii. Number of inmates -30
 - iii. Facilities (mention available facilities) - Full accommodation facilities
 - * Girls' hostel -NA
 - i. Number of hostels
 - ii. Number of inmates
 - iii. Facilities (mention available facilities)
 - * Working women's hostel
 - i. Number of inmates -NA
 - ii. Facilities (mention available facilities)
 - Residential facilities for teaching and non-teaching staff (give numbers available -- cadre wise) - NA
 - Cafeteria -- YES
 - Health centre – YES
- First aid, Inpatient, Outpatient, Emergency care facility, Ambulance...First Aid.
- Health centre staff –
- | | | | | |
|------------------|-----------|--------------------------|-----------|-------------------------------------|
| Qualified doctor | Full time | <input type="checkbox"/> | Part-time | <input checked="" type="checkbox"/> |
| Qualified Nurse | Full time | <input type="checkbox"/> | Part-time | <input checked="" type="checkbox"/> |

- Facilities like banking, post office, book shops - NO
- Transport facilities to cater to the needs of students and staff- NO
- Animal house - NO

- Biological waste disposal - YES
- Generator or other facility for management/regulation of electricity and voltage - YES
- Solid waste management facility - NO
- Waste water management - NO
- Water harvesting - NO

12. Details of programs offered by the college (Give data for current academic year)

Sl. No.	Program Level	Name of the Program/ Course	Duration	Entry Qualification	Medium of instruction	Sanctioned/ approved Student strength	No. of students admitted
	Under-Graduate	B.A, B.Sc. & B.Com.	THREE YEARS	10+2	HINDI & ENGLISH	605	644
	Post-Graduate- (M.A)	HINDI, ECO.& SOCI.	TWO YEARS	Graduation	HINDI	180	154
	Integrated Programs P G	-	-	-	-	-	-
	Ph.D.	-	-	-	-	-	-
	M.Phil.	-	-	-	-	-	-
	Ph. D.	-	-	-	-	-	-
	Certificate courses	-	-	-	-	-	-
	UG Diploma	-	-	-	-	-	-
	PG Diploma	-	-	-	-	-	-
	Any Other (specify and provide details)	-	-	-	-	-	-

13. Does the college offer self-financed Programs?

Yes No

If yes, how many?

14. New programs introduced in the college during the last five years if any?

Yes		No	√	Number	
-----	--	----	---	--------	--

15. List the departments: (respond if applicable only and do not list facilities like Library, Physical Education as departments, unless they are also offering academic degree awarding programs. Similarly, do not list the departments offering common compulsory subjects for all the programs like English, regional languages etc.)

Particulars	UG	PG	Research
Science	Phy. Chem. Math. Zoo.& Botany	-	-
Arts	Hin, Eng. Sans. His. Eco. Soci.& Phy-Edu.	Hindi, Sociology& Economics	-
Commerce	Commerce	-	-
Any Other not covered above	-	-	-

16. Number of Programs offered under (Program means a degree course like BA, BSc,MA,M.Com...)

- a. annual system
- b. semester system
- c. trimester system

17. Number of Programs with

- a. Choice Based Credit System
- b. Inter/Multidisciplinary Approach
- c. Any other (specify and provide details)

18. Does the college offer UG and/or PG programs in Teacher Education?

Yes No

If yes,

a. Year of Introduction of the program(s)..... (dd/mm/yyyy) and number of batches that completed the program

b. NCTE recognition details (if applicable) - NO
 Notification No.:
 Date: (dd/mm/yyyy)
 Validity:.....

c. Is the institution opting for assessment and accreditation of Teacher Education Program separately?

Yes No

~~19. Does the college offer UG or PG program in Physical Education?~~

Yes No

If yes,

- a. Year of Introduction of the program(s)...24-09-2011.... (dd/mm/yyyy)
and number of batches that completed the program
- First batch started 2012

- b. NCTE recognition details (if applicable)
Notification No.: ... **NA**-
Date: (dd/mm/yyyy)
Validity:.....

- c. Is the institution opting for assessment and accreditation of Physical Education Program separately?
Yes No

20. Number of teaching and non-teaching positions in the Institution

Positions	Teaching faculty						Non-teaching staff		Technical staff	
	Professor		Associate Professor		Assistant Professor		*M	*F	*M	*F
	*M	*F	*M	*F	*M	*F				
Sanctioned by the UGC / University / State Government <i>Recruited</i>	-	-	03	01	05	04	11	-	04	-
<i>Yet to recruit</i>	To be filled by transfer. Physics, Chemistry and English									
Sanctioned by the Management/society or other authorized bodies <i>Recruited</i>	-	-	-	-	-	-	-	-	-	-
<i>Yet to recruit</i>	-	-	-	-	-	-	-	-	-	-

*M-Male *F-Female

21. Qualifications of the teaching staff:

Highest qualification	Professor		Associate Professor		Assistant Professor		Total
	Male	Female	Male	Female	Male	Female	
Permanent teachers							
D.Sc./D.Litt.	-	-	-	-	-	-	-
Ph.D.			03	01	04	01	09
M.Phil.	-	-	-	-	-	-	-
PG						03	03
Temporary teachers							
Ph.D.	-	-	-	-	-	-	-
M. Phil.	-	-	-	-	-	-	-
PG	-	-	-	-	-	-	-
Part-time teachers							
Ph.D.	-	-	-	-	-	-	-
M.Phil.	-	-	-	-	-	-	-
PG	-	-	-	-	-	-	-

22. Number of Visiting Faculty /Guest Faculty engaged with the College.

NO

23. Furnish the number of the students admitted to the college during the last four academic years.

Categories	Year 1 2008-09		Year 2 2009-10		Year 3 2010-11		Year 4 2011-12	
	Male	Female	Male	Female	Male	Female	Male	Female
SC	209	308	242	302	161	301	127	263
ST	-	-	-	-	-	-	-	-
OBC	275	371	283	357	190	355	255	651
General	487	682	576	660	351	656	139	389
Others	-	-	-	-	-	-	-	-

24. Details on students enrollment in the college during the current academic year: 2011-12

Type of students	UG	PG	M. Phil.	Ph.D.	Total
Students from the same state where the college is located	1534	290	-	-	1824
Students from other states of India	-	-	-	-	-
NRI students	-	-	-	-	-
Foreign students	-	-	-	-	-
Total	1534	290	-	-	1824

25. Dropout rate in UG and PG (average of the last two batches)

UG

2%

PG

1%

26. Unit Cost of Education

(Unit cost = total annual recurring expenditure (actual) divided by total number of students enrolled)

(a) including the salary component

(b) excluding the salary component

27. Does the college offer any program/s in distance education mode (DEP)?

If yes, Yes No

a) is it a registered centre for offering distance education programs of another University

Yes No

b) Name of the University which has granted such registration.

c) Number of programs offered

d) Programs carry the recognition of the Distance Education Council.

Yes No

28. Provide Teacher-student ratio for each of the program/course offered

B.A-150:1, B.Sc- 30:1, B.Com- 60:1, Phy.Edu.- 60:1

29. Is the college applying for

Accreditation : Cycle 1 Cycle 2 Cycle 3 Cycle 4

Re-Assessment:

(Cycle 1 refers to first accreditation and Cycle 2, Cycle 3 and Cycle 4 refers to re-accreditation)

30. Date of accreditation* (applicable for Cycle 2, Cycle 3, Cycle 4 and re-assessment only)

Cycle 1: ...NA..... (dd/mm/yyyy) Accreditation Outcome/Result.....

Cycle 2: ...NA..... (dd/mm/yyyy) Accreditation Outcome/Result.....

Cycle 3: ...NA..... (dd/mm/yyyy) Accreditation Outcome/Result.....

* **Kindly enclose copy of accreditation certificate(s) and peer team report(s) as an annexure.**

31. Number of working days during the last academic year.

32. Number of teaching days during the last academic year

(Teaching days means days on which lectures were engaged excluding the examination days)

33. Date of establishment of Internal Quality Assurance Cell (IQAC)
 IQAC ...**11-04-2012** (dd/mm/yyyy)
34. Details regarding submission of Annual Quality Assurance Reports (AQAR) to NAAC.
 AQAR (i) ...NA..... (dd/mm/yyyy)
 AQAR (ii) ...NA..... (dd/mm/yyyy)
 AQAR (iii) ...NA..... (dd/mm/yyyy)
 AQAR (iv) ...NA..... (dd/mm/yyyy)
35. Any other relevant data (not covered above) the college would like to include. (Do not include explanatory/descriptive information) – **NO**

C. Criteria-Wise Inputs

CRITERION I: CURRICULAR ASPECTS

1.1 Curriculum Planning and Implementation

- 1.1.1 State the vision, mission and objectives of the institution, and describe how these are communicated to the students, teachers, staff and other stakeholders.

VISION

Indira Gandhi Govt. P. G. College Bangarmau, Unnao (U.P.) strives through sustained efforts to provide need based and skill oriented quality higher education to students from all sections of society for their overall personality development and inculcating moral values among them.

MISSION

- To achieve excellence in teaching, learning and research,
- To provide high quality, accessible, enriching education that prepares students for successful career

Post Graduate education and lifelong learning in a multicultural global and technological society.

- Fostering and encouraging innovation and creativity.
- Communicate effectively in speech and writing.
- Think logically, analytically and creatively.
- Demonstrate mastery of an academic discipline.
- Integrate Moral values into their lives and create an atmosphere of mutual respect.
- Engage in the lifelong search for truth, beauty and justice.
- Create interest among the students for ecology and environment.

OBJECTIVES

- Student empowerment through quality education,
- To inculcate a sense of devotion, perseverance and discipline among the students,
 - To equip the students with intellectual competence,
 - To prepare the students for their participation in socio-political-cultural development of society with a democratic spirit,
 - To instill in the student the quality of leadership,
 - To make the students responsive to needs of society,
 - To prepare the students for innovation and creative qualities,
 - To strengthen the teacher-taught goal oriented relationship,
 - To interact and cooperate with other governmental and non-governmental organizations of skill and proficiency and for advancement in teaching and learning,
 - To develop skill of analysis and research to make the academic programs relevant to useful to the changing and globalizing times,

Vision, mission and objectives are communicated to the students through display on board, website of the college and also in the class rooms by the teachers and the staff through meetings.

1.1.2 How does the institution develop and deploy action plans for effective implementation of the curriculum? Give details of the process and substantiate through specific example(s).

All the teachers prepare their own lesson plans for effective implementation of curriculum and strictly follow them according to time table allotted to them. Copies of the lesson plans of curriculum are given to the Principal and IQAC.

1.1.3 What type of support (procedural and practical) do the teachers receive (from the University and/or institution) for effectively translating the curriculum and improving teaching practices?

- No, University sends printed prospectus only.

1.1.4 Specify the initiatives taken up or contribution made by the institution for effective curriculum delivery and transaction on the Curriculum provided by the affiliating University or other statutory agency.

- At the start of the session, time table and academic calendar are displayed on the notice board and provided to individual teachers and the Principal.
- The institution organizes educational tours, surveys for effective curriculum delivery.

1.1.5 How does the institution network and interact with beneficiaries such as industry, research bodies and the university in effective operationalisation of the curriculum?

- The institution organizes educational tours, surveys for effective curriculum delivery.

1.1.6 What are the contributions of the institution and/or its staff members to the development of the curriculum by the University?(number of staff members/departments represented on the Board of Studies, student feedback, teacher feedback, stakeholder feedback provided, specific suggestions etc.

- Principal takes feedback from the faculty members, students, alumni and parents.

1.1.7 Does the institution develop curriculum for any of the courses offered (other than those under the purview of the affiliating university) by it? If 'yes', give details on the process ('Needs Assessment', design, development and planning) and the courses for which the curriculum has been developed.

- The Curriculum is developed by the affiliating university

1.1.8 How does institution analyse /ensure that the stated objectives of curriculum are achieved in the course of implementation?

- By the Annual Results.
- By taking feedback from the faculty members and students.

1.2 Academic Flexibility

1.2.1 Specifying the goals and objectives give details of the certificate/diploma/ skill development courses etc., offered by the institution.

- Yes
- Different competitions like quiz, essay writing and chart competition at departmental levels for their talent enhancement are organized and certificates are also awarded to motivate them.
- Computer training is given to students for skill development.

1.2.2 Does the institution offer programs that facilitate twinning /dual degree? If 'yes', give details.

- No

1.2.3 Give details on the various institutional provisions with reference to academic flexibility and how it has been helpful to students in terms of skills development, academic mobility, progression to higher studies and improved potential for employability

- Range of Core /Elective options offered by the University and those opted by the college
- Choice Based Credit System and range of subject options- ✓
- Courses offered in modular form
- Credit transfer and accumulation facility
- Lateral and vertical mobility within and across programs and courses
- Enrichment courses

- Career counseling
- Computer training
- Motivation by teachers
- Personality development sessions are organized in each academic session
- Body language at the college level.
- How to prepare resume

1.2.4 Does the institution offer self-financed programs? If ‘yes’, list them and indicate how they differ from other programs, with reference to admission, curriculum, fee structure, teacher qualification, salary etc.

- No

1.2.5 Does the college provide additional skill oriented programs, relevant to regional and global employment markets? If ‘yes’ provide details of such program and the beneficiaries.

- No

1.2.6 Does the University provide for the flexibility of combining the conventional face-to-face and Distance Mode of Education for students to choose the courses/combination of their choice” If ‘yes’, how does the institution take advantage of such provision for the benefit of students?

- No

1.2 Curriculum Enrichment

1.3.1 Describe the efforts made by the institution to supplement the University’s Curriculum to ensure that the academic programs and Institution’s goals and objectives are integrated?

- Educational Tours
- Visit to Historical Places
- Survey of local Industries

These efforts are made by the institution to ensure efficacy of the curriculum.

1.3.2 What are the efforts made by the institution to modify, enrich and organize the curriculum to explicitly reflect the experiences of the students and cater to needs of the dynamic employment market?

- The institution prepares the students through Remedial Classes for Competitive Examinations
- Literature, magazines and printed material are provided by the faculty

1.3.3 Enumerate the efforts made by the institution to integrate the cross cutting issues such as Gender, Climate Change, Environmental Education, Human Rights, ICT etc., into the curriculum?

- **Environmental Education** is a compulsory subject in the University curriculum.

1.3.4 What are the various value-added courses/enrichment programs offered to ensure holistic development of students?

- moral and ethical values
- employable and life skills
- better career options
- community orientation

(a)- In the morning assembly a teacher professes the moral and ethical values and better career option each day.

(b)- Different important days are celebrated to inculcate a sense of moral and ethical values.

1.3.5 Citing a few examples enumerate on the extent of use of the feedback from stakeholders in enriching the curriculum?

- Alumni association gives feedback about the discipline of the college. Parents-teachers meetings are held periodically to take feedback about students and accordingly, steps are taken to enriching the curriculum.

1.3.6 How does the institution monitor and evaluate the quality of its enrichment programs?

- The institution monitors and evaluates the quality of enrichment programs through various contests like debates, speeches, poster displays and essay writing competitions.

- Students are also motivated to participate in inter-collegiate competitions and sports activities.

1.3 Feedback System

1.4.1 What are the contributions of the institution in the design and development of the curriculum prepared by the University?

- Being a Government institution, we follow the curriculum prepared by the university. Sometimes suggestions are made by the teachers.

1.4.2 Is there a formal mechanism to obtain feedback from students and stakeholders on Curriculum? If 'yes', how is it communicated to the University and made use internally for curriculum enrichment and introducing changes/new programs?

- Yes. Feed back is taken from the students as well as parents/guardians and it is then, analyzed by the IQAC and suggestions based thereon are forwarded to the Principal who in turn, calls a general meeting of the teachers to implement the suggestions to enrich teaching-learning process.

1.4.3 How many new programs/courses were introduced by the institution during the last four years? What was the rationale for introducing new courses/programs?)

- Programs and courses are introduced by the University.

Any other relevant information regarding curricular aspects which the college would like to include. **-No**

CRITERION II: TEACHING-LEARNING AND EVALUATION

8.1 Student Enrolment and Profile

8.1.1 How does the college ensure publicity and transparency in the admission process?

- The admission process is notified in news papers
- The merit lists are displayed on the notice board following the reservation rules and in accordance with various Governments orders.

8.1.2 Explain in detail the criteria adopted and process of admission (Ex.(i) merit (ii) common admission test conducted by state agencies and national agencies (iii) combination of merit and entrance test or merit, entrance test and interview (iv) any other) to various programs of the Institution.

- Merit and interview are the criteria adopted by the admission committee for admission process.

2.1.3 Give the minimum and maximum percentage of marks for admission at entry level for each of the programs offered by the college and provide a comparison with other colleges of the affiliating university within the city/district.

- The minimum and maximum percentage of marks for admission in session....

THE MINIMUM AND MAXIMUM PERCENTAGE OF MARKS FOR ADMISSION
FOR2009-10

Marks %	B.A-I			B.Sc-I						B.Com-I			M.A-I								
				Biogoup			Math Group						HINDI			SOCIOLOGY			ECONOMICS		
	Gen	OBC	SC	Gen	OBC	SC	Gen	OBC	SC	Gen	OBC	SC	Gen	OBC	SC	Gen	OBC	SC	Gen	OBC	SC
MAXIMUM	82.6	57	56	-	-	-	-	-	-	-	-	-	41	48	47	64	51	49	-	-	-
MINIMUM	58	48	40	45	45	45	45	45	45	45	45	45	48	40	40	51	47	47	40	40	40

FOR 2010-11

Marks %	B.A-I			B.Sc-I						B.Com-I			M.A-I								
				Biogoup			Math Group						HINDI			SOCIOLOGY			ECONOMICS		
	Gen	OBC	SC	Gen	OBC	SC	Gen	OBC	SC	Gen	OBC	SC	Gen	OBC	SC	Gen	OBC	SC	Gen	OBC	SC
MAXIMUM	83.5	48.6	48	-	-	-	-	-	-	-	-	-	61.5	51	45	62	52	51	-	-	-
MINIMUM	61	40	40	45	45	45	45	45	45	45	45	45	51	48.5	42	52	49	47	40	40	40

FOR 2011-12

Marks %	B.A-I			B.Sc-I						B.Com-I			M.A-I								
				Biogoup			Math Group						HINDI			SOCIOLOGY			ECONOMICS		
	Gen	OBC	SC	Gen	OBC	SC	Gen	OBC	SC	Gen	OBC	SC	Gen	OBC	SC	Gen	OBC	SC	Gen	OBC	SC
MAXIMUM	84.7	61	60	-	-	-	-	-	-	-	-	-	-	-	-	63	52	51	-	-	-
MINIMUM	62	51	40	45	45	45	45	45	45	45	45	45	40	40	40	53	48	43	40	40	40

2.1.4 Is there a mechanism in the institution to review the admission process and student profiles annually? If 'yes' what is the outcome of such an effort and how has it contributed to the improvement of the process?

- The college ensures the transparency in the admission, Hence no need to review the admission process

2.1.5 Reflecting on the strategies adopted to increase/improve access for following categories of students, enumerate on how the admission policy of the institution and its student profiles demonstrate/reflect the National commitment to diversity and inclusion

- * SC/ST
- * OBC
- * Women
- * Differently abled
- * Economically weaker sections
- * Minority community
- * Any other

Being the Government Institutions, the rules of reservation for different categories are strictly followed by the institution and the list of admission is sent to the University and the Director of Higher Education (U.P.)

2.1.6 Provide the following details for various programs offered by the institution during the last four years and comment on the trends. i.e. reasons for increase / decrease and actions initiated for improvement.

2008-09

Programs	Number of applications	Number of students admitted	Demand Ratio
UG			
1. B.A-I	1220	773	1.5:1
2. B.Com-I	75	62	1:1
3. B.Sc-I	267	159	1.5:1
PG			
1. Hindi	116	61	2:1
2. Economics	75	56	1:1
3. Sociology	136	61	2:1
M.Phil.	-	-	-
Ph.D.	-	-	-
Integrated PG Ph.D.	-	-	-
Value added	-	-	-
1			
2			
3			
Certificate	-	-	-
1			
2			
3			
Diploma	-	-	-
1			
2			
PG Diploma	-	-	-
1			
2			
3			
Any other	-	-	-
1			
2			
3			

2009-10

Programs	Number of applications	Number of students admitted	Demand Ratio
UG			
1. B.A-I	1371	525	2.5:1
2. B.Com-I	80	70	8:7
3. B.Sc-I	175	128	7:5
PG			
1. Hindi	105	60	1.5:1
2. Economics	60	50	6:5
3. Sociology	130	60	2:1
M.Phil.	-	-	-
Ph.D.	-	-	-
Integrated PG Ph.D.	-	-	-
Value added	-	-	-
1			
2			
3			
Certificate	-	-	-
1			
2			
3			
Diploma	-	-	-
1			
2			
PG Diploma	-	-	-
1			
2			
3			
Any other	-	-	-
1			
2			
3			

2010-11

Programs	Number of applications	Number of students admitted	Demand Ratio
UG			
1. B.A-I	694	420	1.5:1
2. B.Com-I	50	47	1:1
3. B.Sc-I	100	75	1.5:1
PG			
1. Hindi	80	60	1.2:1
2. Economics	76	60	1:1
3. Sociology	119	60	2:1
M.Phil.	-	-	-
Ph.D.	-	-	-
Integrated PG Ph.D.	-	-	-
Value added	-	-	-
1			
2			
3			
Certificate	-	-	-
1			
2			
3			
Diploma	-	-	-
1			
2			
PG Diploma	-	-	-
1			
2			
3			
Any other	-	-	-
1			
2			
3			

2011-12

Programs	Number of applications	Number of students admitted	Demand Ratio
UG			
1. B.A-I	910	525	2:1
2. B.Com-I	50	41	1:1
3. B.Sc-I	100	78	1.5:1
PG			
1. Hindi	112	60	2:1
2. Economics	42	40	1:1
3. Sociology	130	60	2.5:1
M.Phil.	-	-	-
Ph.D.	-	-	-
Integrated PG Ph.D.	-	-	-
Value added	-	-	-
1			
2			
3			
Certificate	-	-	-
1			
2			
3			
Diploma	-	-	-
1			
2			
PG Diploma	-	-	-
1			
2			
3			
Any other	-	-	-
1			
2			
3			

- Being a Government Institution there is no change entrance

2.2 Catering to Diverse Needs of Students

2.2.1 How does the institution cater to the needs of differently-abled students and ensure adherence to government policies in this regard?

- Ramp is already constructed in the college for physically disabled students and a peon is also deputed for their help.
- 2% reservation to differently-abled students is provided as per government rule.

2.2.2 Does the institution assess the students' needs in terms of knowledge and skills before the commencement of the program? If 'yes', give details on the process.

- The institution assesses the knowledge and skills of the students through interaction.

2.2.3 What are the strategies drawn and deployed by the institution to bridge the knowledge gap of the enrolled students to enable them to cope with the program of their choice? (Bridge/Remedial/Add-on/Enrichment Courses, etc.)

- Remedial Teaching
- Tutorials

2.2.4 How does the college sensitize its staff and students on issues such as gender, inclusion, environment etc.?

- Being co-educational institution, different programs are organized on the issues such as gender equality and environmental related programs. Likewise, equal participation in different programs is ensured to motivate the staff and students for plantation and environment restoration. To maintain greenery and oxygen in the atmosphere, in addition to above programs, debates, seminars and quiz competitions are also organized.

2.2.5 How does the institution identify and respond to special educational/learning needs of advanced learners?

- To create special interest in ICT (Information and Communication Technology).

- Internet is available for students.
- Personal guidance is given to students by the faculty.

2.2.6 How does the institute collect, analyze and use the data and information on the academic performance (through the program duration) of the students at risk of drop out (students from the disadvantaged sections of society, physically challenged, slow learners, economically weaker sections etc.)?

- The tutorial classes are held for slow learners.
- Books are provided to the learners from economically weaker section.
- The free-ship is awarded to the weaker section learners.
- The remedial classes are also organized for slow learners.

2.3 Teaching-Learning Process

2.3.1 How does the college plan and organize the teaching, learning and evaluation schedules? (Academic calendar, teaching plan, evaluation blue print, etc.)

- Academic calendar is introduced at beginning of the session by the College.
- Teaching plans are made by the teachers to make the teaching effective.
- Recently started monthly test for evaluation of the students.

2.3.2 How does IQAC contribute to improve the teaching –learning process?

Yes, IQAC monitors the :-

- Curriculum implementation ‘
- Quality of teaching-learning
- Attendance of students
- Participation of students in extra-curricular activities.
- Students’ complaints redressal cell.
- Students’ basic requirements.

2.3.3 How is learning made more student-centric? Give details on the support structures and systems available for teachers to develop skills like interactive learning, collaborative learning and independent learning among the students?

- The teachers make the learning more students-centric through interaction and collaborative exercises.
- Our institution is a Govt. college where students come from different areas of Bangarmau. Teaching is imparted through knowledge transmission from teacher to students. The students of undergraduate level act as passive media but, at P.G. level teaching is made students centric and teacher acts as facilitator of learning experiences. The faculty guides the students for participation in discussions, seminars, workshops and interactive sessions.

2.3.4 How does the institution nurture critical thinking, creativity and scientific temper among the students to transform them into life-long learners and innovators?

- The institutions organizes different programs such as seminars, workshops, poster competitions, visits to historical places and scientific places to make thinking analytical and nurture scientific temper among the learners.

2.3.5 What are the technologies and facilities available and used by the faculty for effective teaching? e.g. Virtual laboratories, e-learning - resources from National Program on Technology Enhanced Learning (NPTEL) and National Mission on Education through Information and Communication Technology (NME-ICT), open educational resources, mobile education, etc.

- Faculty members make use of lecture-method, charts, models and projectors for teaching.

2.3.6 How are the students and faculty exposed to advanced level of knowledge and skills (blended learning, expert lectures, seminars, workshops etc.)?

- Guest lectures, seminars and workshops are organized by the faculty to expose the faculty as well as students to knowledge and skills.

2.3.7 Detail (process and the number of students \benefitted) on the academic, personal and psycho-social support and guidance services (professional counseling/mentoring/academic advise) provided to students?

- Career counseling is provided to the students by the institution through establishment of employment and guidance cell.

2.3.8 Provide details of innovative teaching approaches/methods adopted by the faculty during the last four years? What are the efforts made by the institution to encourage the faculty to adopt new and innovative approaches and the impact of such innovative practices on student learning?

- Besides the traditional teaching method, the faculty adopts the innovative teaching methods like demonstrations, programs, practical and interaction with the student too.

2.3.9 How are library resources used to augment the teaching-learning process?

- Library resources like books, journals, news papers, magazines and proceedings are used by the faculty to enhance the level of knowledge among the students.

2.3.10 Does the institution face any challenges in completing the curriculum within the planned time frame and calendar? If 'yes', elaborate on the challenges encountered and the institutional approaches to overcome these.

- No, The institution completes the curriculum within the planned time frame and calendar.

2.3.11 How does the institute monitor and evaluate the quality of teaching learning?

- The IQAC consisting of senior teachers evaluates the quality of teaching-learning process and advises them to improve teaching.
- The monthly test and is organized by the institution to evaluate the learning process.

2.4 Teacher Quality

2.4.1 Provide the following details and elaborate on the strategies adopted by the college in planning and management (recruitment and retention) of its human resource (qualified and competent teachers) to meet the changing requirements of the curriculum

Highest qualification	Professor		Associate Professor		Assistant Professor		Total
	Male	Female	Male	Female	Male	Female	
Permanent teachers							
D.Sc./D.Litt.							
Ph.D.			03	01	04	01	09
M.Phil.							
PG						03	03
Temporary teachers							
Ph.D.							
M.Phil.							
PG							
Part-time teachers							
Ph.D.							
M.Phil.							
PG							

2.4.2 How does the institution cope with the growing demand/ scarcity of qualified senior faculty to teach new programs/ modern areas (emerging areas) of study being introduced (Biotechnology, IT, Bioinformatics etc.)? Provide details on the efforts made by the institution in this direction and the outcome during the last three years.

- Yes, faculty members are sent to participate in orientation, refresher courses and workshops to upgrade their knowledge in new programs.

2.4.3 Providing details on staff development programs during the last four years elaborate on the strategies adopted by the institution in enhancing the teacher quality.

a) Nomination to staff development programs

Academic Staff Development Programs	Number of faculty nominated
Refresher courses	02
HRD programs	No
Orientation programs	02
Staff training conducted by the university	05
Staff training conducted by other institutions	No
Summer / winter schools, workshops, etc.	03

b) Faculty Training programs organized by the institution to empower and enable the use of various tools and technology for improved teaching-learning

Teaching learning methods/approaches-	√
❖ Handling new curriculum	√
❖ Content/knowledge management	
❖ Selection, development and use of enrichment materials	√
❖ Assessment	√
❖ Cross cutting issues	√
❖ Audio Visual Aids/multimedia	√
❖ OER's	
❖ Teaching learning material development, selection and use	√

c) Percentage of faculty

- * invited as resource persons in Workshops / Seminars / Conferences organized by external professional agencies- 10%
- * participated in external Workshops/Seminars / Conferences recognized by national/ international professional bodies - 100%
- * presented papers in Workshops/ Seminars / Conferences conducted or recognized by professional agencies- 20%

2.4.4 What policies/systems are in place to recharge teachers? (e.g.: providing research grants, study leave, support for research and academic publications teaching experience in other national institutions and specialized programs industrial engagement etc.)

- NO.

2.4.5 Give the number of faculty who received awards / recognition at the state, national and international level for excellence in teaching during the last four years. Enunciate how the institutional culture and environment contributed to such performance/achievement of the faculty.

- NO

2.4.6 Has the institution introduced evaluation of teachers by the students and external Peers? If yes, how is the evaluation used for improving the quality of the teaching-learning process?

- Yes, Feedback is taken from the students for improving the quality of teaching-learning process.

2.5 Evaluation Process and Reforms

2.5.1 How does the institution ensure that the stakeholders of the institution especially students and faculty are aware of the evaluation processes?

- Monthly test is conducted by the institution to ensure the stakeholders of evaluation process.

2.5.2 What are the major evaluation reforms of the university that the institution has adopted and what are the reforms initiated by the institution on its own?

- Annual examination is the major evaluation reform by the university which is adopted by the institution.

2.5.3 How does the institution ensure effective implementation of the evaluation reforms of the university and those initiated by the institution on its own?

- The direction of the university regarding the evaluations reforms are strictly followed by the institution from time to time.

2.5.4 Provide details on the formative and summative evaluation approaches adapted to measure student achievement. Cite a few examples which have positively impacted the system.

- Monthly tests and final (annual) examination are main measures adopted to evaluate the student's achievement.

2.5.5 Enumerate on how the institution monitors and communicates the progress and performance of students through the duration of the course/program? Provide an analysis of the students results/achievements (Program/course wise for last four years) and explain the differences if any and patterns of achievement across the programs/courses offered.

- The institutions monitors the performance of the students by conducting monthly test and communicates the progress and performance of the students through quarterly parents teachers meetings.

2.5.6 Detail on the significant improvements made in ensuring rigor and transparency in the internal assessment during the last four years and weightages assigned for the overall development of students (weightage for behavioral aspects, independent learning, communication skills etc.

- The transparent internal assessment system is adopted by the institution through showing answer books and test books to the student and parents.

2.5.7 Does the institution and individual teachers use assessment/evaluation as an indicator for evaluating student performance, achievement of learning objectives and planning? If 'yes' provide details on the process and cite a few examples.

Yes,

- Marks obtained by the students in the class test.
- Marks obtained by the students in half yearly examination.
- Group discussions.
- Class seminars.

2.5.8 What are the mechanisms for redressal of grievances with reference to evaluation both at the college and University level?

- Grievance redressal cell is already established in the college.
- Grievances related to the university like correction in mark sheets are forwarded to the University by the college.

2.6 Student performance and Learning Outcomes

2.6.1 Does the college have clearly stated learning outcomes? If 'yes' give details on how the students and staff are made aware of these?

- Mission and objectives clearly state learning outcomes which are prominently displayed to make the students and staff members aware of these.

2.6.2 How are the teaching, learning and assessment strategies of the institution structured to facilitate the achievement of the intended learning outcomes?

- Teaching strategies – Lecture Method, E-learning, Tutorial.
- Learning strategies – Interaction with students, group's discussions and class seminars.
- Assessment strategies – Monthly tests and annual examination.

2.6.3 What are the measures/initiatives taken up by the institution to enhance the social and economic relevance (quality Jobs, entrepreneurship, innovation and research aptitude) of the courses offered?

- The basic traditional courses like B.A., B.Com. and B.Sc. are offered by institution. However, the students are counseled to enhance social and economic relevance from these courses. (Qualities Jobs entrepreneurship, innovation and research aptitude)

2.6.4 How does the institution collect and analyse data on student learning outcomes and use it for planning and overcoming barriers of learning?

- The institution analyzes the result of monthly test and annual examination to evaluate the students' learning outcomes and this tool is used for planning and overcoming barriers of learning.

2.6.5 How does the institution monitor and ensure the achievement of learning outcomes

- The institution monitors and ensures the achievement of learning outcomes through feedback from the students.

2.6.6 What are the graduates attributes specified by the college/affiliating university? How does the college ensure the attainment of these by the students?

- The College awards prizes and certificates at its own level to the students who secure highest marks in their respective disciplines. This act of the College exhorts the students to attain extraordinary success both at the level of College and the University. The University awards medals to the students of extraordinary attainments. The College prepares students for extraordinary attainments by way of personal guidance and through interactive sessions.

Any other relevant information regarding Teaching-Learning and Evaluation which the college would like to include. -No

CRITERION III: RESEARCH, CONSULTANCY AND EXTENSION

10.1 Promotion of Research

3.1.1 Does the institution have recognized research center/s of the affiliating University or any other agency/organization?

- No,

3.1.2 Does the Institution have a research committee to monitor and address the issues of research? If so, what is its composition? Mention a few recommendations made by the committee for implementation and their impact.

- Yes,
- Individual faculty members are engaged in research work, they participate in seminars, conferences workshops and publish their research papers in journals.
- The Research Committee has recommended for undertaking Minor research projects by the faculty with the financial aid from the UGC and other funding agencies.

3.1.3 What are the measures taken by the institution to facilitate smooth progress and implementation of research schemes/projects?

- autonomy to the principal investigator
- timely availability or release of resources
- adequate infrastructure and human resources
- time-off, reduced teaching load, special leave etc. to teachers
- support in terms of technology and information needs
- facilitate timely auditing and submission of utilization certificate to the funding authorities
- any other

3.1.4 What are the efforts made by the institution in developing scientific temper and research culture and aptitude among students?

- Class seminars are organized by institutions to develop scientific temper and attitude among students.

3.1.5 Give details of the faculty involvement in active research (Guiding student research, leading Research Projects, engaged in individual/collaborative research activity, etc.

- Some faculty members are involved in guiding students for research.

Dr. Vishnu Mishra- Assistant Professor- Physical Education- Supervised
Student Name-

Brijesh Kumar Srivastava- **Title-** [A Comparative Study of the Effects of
Hatha Yoga and Meditation on Mood Elevation]

3.1.6 Give details of workshops/ training programs/ sensitization programs conducted/organized by the institution with focus on capacity building in terms of research and imbining research culture among the staff and students.

- No

3.1.7 Provide details of prioritised research areas and the expertise available with the institution.

- No

3.1.8 Enumerate the efforts of the institution in attracting researchers of eminence to visit the campus and interact with teachers and students?

- Some guest lecture to be held shortly to attract the researchers.

3.1.9 What percentage of the faculty has utilized Sabbatical Leave for research activities? How has the provision contributed to improve the quality of research and imbibe research culture on the campus?

- No

3.1.10 Provide details of the initiatives taken up by the institution in creating awareness/advocating/transfer of relative findings of research of the institution and elsewhere to students and community (lab to land)

- The journals, dissertations and research thesis are available in the institution for creating awareness of research.

3.2 Resource Mobilization for Research

3.2.1 What percentage of the total budget is earmarked for research? Give details of major heads of expenditure, financial allocation and actual utilization.

- No

3.2.2 Is there a provision in the institution to provide seed money to the faculty for research? If so, specify the amount disbursed and the percentage of the faculty that has availed the facility in the last four years?

- No.

3.2.3 What are the financial provisions made available to support student research projects by students?

- No.

3.2.4 How does the various departments/units/staff of the institute interact in undertaking inter-disciplinary research? Cite examples of successful endeavors and challenges faced in organizing interdisciplinary research.

- No.

3.2.5 How does the institution ensure optimal use of various equipment and research facilities of the institution by its staff and students?

- No.

3.2.6 Has the institution received any special grants or finances from the industry or other beneficiary agency for developing research facility? If 'yes' give details.

- No.

3.2.7 Enumerate the support provided to the faculty in securing research funds from various funding agencies, industry and other organisations. Provide details of ongoing and completed projects and grants received during the last four years.

- No.

Nature of the Project	Duration Year From To	Title of the project	Name of the funding agency	Total grant		Total grant received till date
				Sanctioned	Received	
Minor projects	-	-	-	-	-	-
Major projects	-	-	-	-	-	-
Interdisciplinary projects	-	-	-	-	-	-
Industry sponsored	-	-	-	-	-	-
Students' research projects	-	-	-	-	-	-
Any other (specify)	-	-	-	-	-	-

3.3 Research Facilities

3.3.1 What are the research facilities available to the students and research scholars within the campus?

- No.

3.3.2 What are the institutional strategies for planning, upgrading and creating infrastructural facilities to meet the needs of researchers especially in the new and emerging areas of research?

- No.

3.3.3 Has the institution received any special grants or finances from the industry or other beneficiary agency for developing research facilities?? If 'yes', what are the instruments/ facilities created during the last four years.

- No.

3.3.4 What are the research facilities made available to the students and research scholars outside the campus / other research laboratories?

- Literature

3.3.5 Provide details on the library/ information resource centre or any other facilities available specifically for the researchers?

- Research Journals.

3.3.6 What are the collaborative research facilities developed / created by the research institutes in the college. For ex. Laboratories, library, instruments, computers, new technology etc.

- No.

3.4 Research Publications and Awards

3.4.1 Highlight the major research achievements of the staff and students in terms of

- * Patents obtained and filed (process and product)
Original research contributing to product improvement
- * Research studies or surveys benefiting the community or improving the services-√
- * Research inputs contributing to new initiatives and social development-√

Research publications by the individual faculty members.

3.4.2 Does the Institute publish or partner in publication of research journal(s)? If 'yes', indicate the composition of the editorial board, publication policies and whether such publication is listed in any international database?

- No.

3.4.3 Give details of publications by the faculty and students:

- * Publication per faculty – Listed in the evaluative report of the respective department
- * Number of papers published by faculty and students in peer reviewed journals (national / international)
- * Number of publications listed in International Database (for Eg: Web of Science, Scopus, Humanities International Complete, Dare Database - International Social Sciences Directory, EBSCO host, etc.)
- * Monographs
- * Chapter in Books
- * Books Edited
- * Books with ISBN/ISSN numbers with details of publishers
- * Citation Index
- * SNIP
- * SJR
- * Impact factor
- * h-index

3.4.4 Provide details (if any) of _____ - No

- * research awards received by the faculty
- * recognition received by the faculty from reputed professional bodies and agencies, nationally and internationally
- * Incentives given to faculty for receiving state, national and international recognitions for research contributions.

3.5 Consultancy

3.5.1 Give details of the systems and strategies for establishing institute-industry interface?

- No

3.5.2 What is the stated policy of the institution to promote consultancy? How is the available expertise advocated and publicized?

- No

3.5.3 How does the institution encourage the staff to utilize their expertise and available facilities for consultancy services?

- No.

3.5.4 List the broad areas and major consultancy services provided by the institution and the revenue generated during the last four years.

- No.

3.5.5 What is the policy of the institution in sharing the income generated through consultancy (staff involved: Institution) and its use for institutional development?

- No.

3.6 Extension Activities and Institutional Social Responsibility (ISR)

3.6.1 How does the institution promote institution-neighborhood-community network and student engagement, contributing to good citizenship, service orientation and holistic development of students?

- Through the Rovers-Rangers programs, different national and Memorial Day's celebrations are made. The students contributed to polio-elimination program and voter awareness program held on 25th January and rally was also held to create awareness among the students about voting right for strengthening of democracy.

3.6.2 What is the Institutional mechanism to track students' involvement in various social movements / activities which promote citizenship roles?

- The debate competition and poster consisting of "slogan " displayed on that very day (voters day)

3.6.3 How does the institution solicit stakeholder perception on the overall performance and quality of the institution?

- The institution solicits the members of the alumni association for making suggestion to improve the quality and performance of the institution.

3.6.4 How does the institution plan and organize its extension and outreach programs? Providing the budgetary details for last four years, list the major extension and outreach programs and their impact on the overall development of students.

- Being a government institution no extra budget is allotted for organizing these programs. Yet the extension programs are organized by the institution for overall development with its own resources.

3.6.5 How does the institution promote the participation of students and faculty in extension activities including participation in NSS, NCC, YRC and other National/International agencies?

- The institution has applied for the establishment of NSS, unit to C.S.J.M University Kanpur.

3.6.6 Give details on social surveys, research or extension work (if any) undertaken by the college to ensure social justice and empower students from under-privileged and vulnerable sections of society?

- No.

3.6.7 Reflecting on objectives and expected outcomes of the extension activities organized by the institution, comment on how they complement students' academic learning experience and specify the values and skills inculcated.

- The institution promotes the community network and the students are involved in contribution to good citizenship through organizing the extension activities stated in 3.6.1 {ISR and extension activity}.

3.6.8 How does the institution ensure the involvement of the community in its reach out activities and contribute to the community development? Detail on the initiatives of the institution that encourage community participation in its activities?

- No

3.6.9 Give details on the constructive relationships forged (if any) with other institutions of the locality for working on various outreach and extension activities.

- No.

3.6.10 Give details of awards received by the institution for extension activities and/contributions to the social/community development during the last four years.

- The Certificate of Excellence is awarded to the students by the administrative officer of the district administration for their excellent work in extension activities.

3.7 Collaboration

3.7.1 How does the institution collaborate and interact with research laboratories, institutes and industry for research activities. Cite examples and benefits accrued of the initiatives - collaborative research, staff exchange, sharing facilities and equipment, research scholarships etc.

- No

3.7.2 Provide details on the MoUs/collaborative arrangements (if any) with institutions of national importance/other universities/ industries/Corporate (Corporate entities) etc. and how they have contributed to the development of the institution.

- No

3.7.3 Give details (if any) on the industry-institution-community interactions that have contributed to the establishment / creation/up-gradation of academic facilities, student and staff support, infrastructure facilities of the institution viz. laboratories / library/ new technology /placement services etc.

- No.

3.7.4 Highlighting the names of eminent scientists/participants who contributed to the events, provide details of national and international conferences organized by the

college during the last four years.

- No.

3.7.5 How many of the linkages/collaborations have actually resulted in formal MoUs and agreements? List out the activities and beneficiaries and cite Examples (if any) of the established linkages that enhanced and/or facilitated -

No

- a) Curriculum development/enrichment
- b) Internship/ On-the-job training
- c) Summer placement
- d) Faculty exchange and professional development
- e) Research
- f) Consultancy
- g) Extension
- h) Publication
- i) Student Placement
- j) Twinning programs
- k) Introduction of new courses
- l) Student exchange
- m) Any other

3.7.6 Detail on the systemic efforts of the institution in planning, establishing and implementing the initiatives of the linkages/collaborations.

- No.

Any other relevant information regarding Research, Consultancy and Extension which the college would like to include.

CRITERION IV: INFRASTRUCTURE AND LEARNING RESOURCES

4.1 Physical Facilities

4.1.1 What is the policy of the Institution for creation and enhancement of infrastructure that facilitate effective teaching and learning?

- Being a government institution, the State Government provides grants in every financial year to create and enhance the infrastructure for effective teaching and learning.

4.1.2 Detail the facilities available for

a) Curricular and co-curricular activities – classrooms, technology enabled learning spaces, seminar halls, tutorial spaces, laboratories, botanical garden, Animal house, specialized facilities and equipment for teaching, learning and research etc.

b) Extra –curricular activities – sports, outdoor and indoor games, gymnasium, auditorium, NSS, NCC, cultural activities, Public speaking, communication skills development, yoga, health and hygiene etc.

- The facilities available for

b) Curricular and co-curricular activities- Classroom, Technology enabled learning spaces, seminar halls, tutorial spaces, laboratories, specialized facilities and equipment for teaching, and learning.

b) Extra –curricular activities – sports, outdoor and indoor games, gymnasium, auditorium, cultural activities, Public speaking, communication skills development, yoga, health and hygiene, Rangers etc.

4.1.3 How does the institution plan and ensure that the available infrastructure is in line with its academic growth and is optimally utilized? Give specific examples of the facilities developed/augmented and the amount spent during the last four years (Enclose the Master Plan of the Institution/ campus and indicate the existing physical infrastructure and the future planned expansions if any).

- Being the Government Institution, the State Government is liable to provide financial assistance to create infrastructure in accordance with the need and norms and the infrastructure so created is maintained properly and put to optimum use.(Master Plan enclosed)

4.1.4 How does the institution ensure that the infrastructure facilities meet the requirements of students with physical disabilities?

- Ramp is already constructed to meet the requirement of the student with physical disabilities and a peon is appointed to assist them.

4.1.5 Give details on the residential facility and various provisions available within them:

- Hostel Facility – Accommodation available- **30 Beds**
- Recreational facilities, gymnasium, yoga center, etc. -**gymnasium, yoga center**
- Computer facility including access to internet in hostel **-No**
- Facilities for medical emergencies **First-aid facilities**
- Library facility in the hostels **- No**
- Internet and Wi-Fi facility **-Only in campus**
- Recreational facility-common room with audio-visual equipments- **No**
- Available residential facility for the staff and occupancy Constant supply of safe drinking water- **-Safe drinking water facilities available for students only.**
- Security- **-Night watchman is already appointed for the security.**

4.1.6 What are the provisions made available to students and staff in terms of health care on the campus and off the campus?

- The first aid facilities are available in the campus only.

4.1.7 Give details of the Common Facilities available on the campus –spaces for special units like IQAC, Grievance Redressal unit, Women’s Cell, Counseling and Career Guidance, Placement Unit, Health Centre, Canteen, recreational spaces for staff and students, safe drinking water facility, auditorium, etc.

- The common facilities like grievance redressal unit, women’s cell ,counseling and career guidance, health centre, Canteen, safe drinking water facilities, auditorium, internet and wimax facility for staff and students both are available in the Campus.

4.2 Library as a Learning Resource

4.2.1 Does the library have an Advisory Committee? Specify the composition of such a committee. What significant initiatives have been implemented by the committee to render the library, student/user friendly?

- Yes, The advising committee- Dr. Ranjna Sinha-
Incharge Librarian
Dr. V.K. Mishra - Member
Dr. Sadhana Gupta- Member
Dr. Vishnu Mishra- Member
Savita Rajan - Member

The advisory committee keeps close vigil on issue of the books to the staff and students, cataloguing, classification, purchasing and listing of books.

4.2.2 Provide details of the following:

- * Total area of the library (in Sq. Mts.)- -11 m x 9m.
- * Total seating capacity -50 seats.
- * Working hours (on working days, on holidays, before examination days, during examination days, during vacation) -7 hours during working days.
- * Layout of the library (individual reading carrels, lounge area for browsing and relaxed reading, IT zone for accessing e-resources) - Reading facilities is available.

4.2.3 How does the library ensure purchase and use of current titles, print and e-journals and other reading materials? Specify the amount spent on procuring new books, journals and e-resources during the last four years.

Library holdings	Year -1 2008-09		Year – 2 2009-10		Year – 3 2010-11		Year – 4 2011-12	
	Number	Total Cost	Number	Total Cost	Number	Total Cost	Number	Total Cost
Text books	2251	247637	255	68955	649	279891	-	-
Reference Books	05	2363	28	23993	-	-	-	-
Journals/ Periodicals	-	-	-	-	-	-	-	-
e-resources	-	-	-	-	-	-	-	-
Any other (specify)	-	-	-	-	-	-	-	-

4.2.4 Provide details on the ICT and other tools deployed to provide maximum Access to the library collection?

- * OPAC (Online Public Access Catalogue) - Yes
- * Electronic Resource Management package for e-journals - No
- * Federated searching tools to search articles in multiple databases - No
- * Library Website - No
- * In-house/remote access to e-publications - No
- * Library automation - Yes
- * Total number of computers for public access -01
- * Total numbers of printers for public access -01
- * Internet band width/ speed 2mbps 10 mbps 1 gb (GB) -1 GB
- * Institutional Repository -Available
- * Content management system for e-learning - No
- * Participation in Resource sharing networks/consortia (like Inflibnet) - No

4.2.5 Provide details on the following items:

- * Average number of walk-ins -125
- * Average number of books issued/returned -issued-250 & returned 70
- * Ratio of library books to students enrolled -1:513

- * Average number of books added during last three years - 7104
- * Average number of login to opac (OPAC) -No
- * Average number of login to e-resources -No
- * Average number of e-resources downloaded/printed -No
- * Number of information literacy trainings organized -No
- * Details of “weeding out” of books and other materials -No

4.2.6 Give details of the specialized services provided by the library

- * Manuscripts - No
- * Reference - Yes
- * Reprography - No
- * ILL (Inter Library Loan Service) - No
- * Information deployment and notification (Information Deployment and Notification)- - Yes
- * Download - No
- * Printing - No
- * Reading list/ Bibliography compilation - Yes
- * In-house/remote access to e-resources - No
- * User Orientation and awareness - No
- * Assistance in searching Databases - No
- * INFLIBNET/IUC facilities -Some Books are related to computer

4.2.7 Enumerate on the support provided by the Library staff to the students and teachers of the college.

- The books, reference books, news papers, periodicals and competitive magazines are provided by the library staff to students and teachers.

4.2.8 What are the special facilities offered by the library to the visually/physically challenged persons? Give details.

- Library staff assists the physically disabled students in searching books.

4.2.9 Does the library get the feedback from its users? If yes, how is it analysed and used for improving the library services. (What strategies are deployed by the Library to collect feedback from users? How is the feedback analysed and used for further improvement of the library services?)

- A brief feed back note book is available in the Reading-Room for giving the feed back by the students and teachers. The advisory committee of the library analysis the feed back given by the students and teachers and issues the instructions to library staff for further improvement.

4.3 IT Infrastructure

4.3.1. Give details on the computing facility available (hardware and software) at the institution.

- Number of computers with Configuration (provide actual number with exact configuration of each available system) -16
- Computer-student ratio in each batch -1:30
- Stand alone facility - No
- LAN facility - Yes
- Licensed software -No
- Number of nodes/ computers with Internet facility -10
- Any other- The Computer facility with internet has been provided to five departments.,

Zoology, Physics, Commerce, Physical Education and Principal's office.

4.3.2 Detail on the computer and internet facility made available to the faculty and students on the campus and off-campus?

- The institution has computer lab with broad band internet facility for the students and separate computer facility to the departments – Commerce, Physics, Zoology, Physical Education and Principal's Office.

4.3.3 What are the institutional plans and strategies for deploying and upgrading the IT infrastructure and associated facilities?

- The institution has provided internet connection to all the computers of computer lab as well as departmental computers for up-gradation of the infra structure.

4.3.4 Provide details on the provision made in the annual budget for procurement, upgradation, deployment and maintenance of the computers and their accessories in the institution (Year wise for last four years)

- 2008-09 - Rs.10000
- 2009-10 - Rs.15000
- 2010-11 - Rs.15000 + UGC - Rs.150000)
- 2011-12 - Rs.21000

4.3.5 How does the institution facilitate extensive use of ICT resources including development and use of computer-aided teaching/ learning materials by its staff and students?

- The institution uses the ICT for effective teaching and learning.

4.3.6 Elaborate giving suitable examples on how the learning activities and technologies deployed (access to on-line teaching - learning resources, independent learning, ICT enabled classrooms/learning spaces etc.) by the institution place the student at the centre of teaching-learning process and render the role of a facilitator for the teacher.

- The projector and independent learning resources are deployed at the learning spaces by the institution.

4.3.7 Does the Institution avail of the National Knowledge Network connectivity directly or through the affiliating university? If so, what are the services availed of?

- No.

4.4 Maintenance of Campus Facilities

4.4.1 How does the institution ensure optimal allocation and utilization of the available financial resources for maintenance and upkeep of the following facilities (substantiate your statements by providing details of budget allocated during last four years)?

2008-09

Sl. No	Items	Allocation budget		Utilization		Balance	
		State Govt.	U.G.C	State Govt.	U.G.C	State Govt.	U.G.C
a.	Building	-	-	-	-	-	-
b.	Furniture	20000	-	19875	-	125	-
c.	Equipment	-	-	-	-	-	-
d.	Computers	10000	-	10000	-	-	-
e.	Vehicles	-	-	-	-	-	-
f.	Any other (Office Stationary, Telephone, Computer repair maintenance)	360500	-	355890	-	4610	-

2009-10

Sl. No	Items	Allocation budget		Utilization		Balance	
		State Govt.	U.G.C	State Govt.	U.G.C	State Govt.	U.G.C
a.	Building	-	-	-	-	-	-
b.	Furniture	100000	-	100000	-	-	-
c.	Equipment	300000	372335	300000	372335	-	-
d.	Computers	15000	-	15000	-	-	-
e.	Vehicles	-	-	-	-	-	-
f.	Any other (Office Stationary, Telephone, Computer repair maintenance)	168290	-	162197	-	6093	-

2010-11

Sl. No	Items	Allocation budget		Utilization		Balance	
		State Govt.	U.G.C	State Govt.	U.G.C	State Govt.	U.G.C
a.	Building	-	-	-	-	-	-
b.	Furniture	100000	-	100000	-	-	-
c.	Equipment	500000	320000	500000	320000	-	-
d.	Computers	15000	150000	15000	150000	-	-
e.	Vehicles	-	-	-	-	-	-
f.	Any other (Office Stationary, Telephone, Computer repair maintenance)	453420	320000	453420	320000	-	-

2011-12

Sl. No	Items	Allocation budget		Utilization		Balance	
		State Govt.	U.G.C	State Govt.	U.G.C	State Govt.	U.G.C
a.	Building	-	-	-	-	-	-
b.	Furniture	-	-	-	-	-	-
c.	Equipment	200000	-	200000	-	-	-
d.	Computers	21000	-	21000	-	-	-
e.	Vehicles	-	-	-	-	-	-
f.	Any other (Office Stationary, Telephone, Computer repair maintenance)	698726	-	698726	-	-	-

4.4.2 What are the institutional mechanisms for maintenance and upkeep of the infrastructure, facilities and equipment of the college?

- A standing committee is already formed to keep close vigil on maintenance, up keep of the infrastructure and equipments of the college.

4.4.3 How and with what frequency does the institute take up calibration and other precision measures for the equipment/instruments?

- The heads of the department and lab assistants particularly in the science faculty take up precision measures to maintain the equipment and instrument from time to time.

4.4.4 What are the major steps taken for location, upkeep and maintenance of sensitive equipment(voltage fluctuations, constant supply of water etc.)?

- Voltage stabilizers and sensitive equipment like UPS are fitted to Photostat machine, water cooler and refrigerators to cope with the voltage fluctuations.

Any other relevant information regarding Infrastructure and Learning Resources which the college would like to include. -No

CRITERION V: STUDENT SUPPORT AND PROGRESSION

5.1 Student Mentoring and Support

5.1.1 Does the institution publish its updated prospectus/handbook annually? If 'yes', what is the information provided to students through these documents and how does the institution ensure its commitment and accountability?

- The institution publishes updated prospectus every year consisting of the activities to be done by the students and other information regarding admission, classroom arrangements, faculties available, examination system and environmental entities.

5.1.2 Specify the type, number and amount of institutional scholarships / freeships given to the students during the last four years and whether the financial aid was available and disbursed on time?

- The trust (People of Bangarmau donated fund of Rs.171000) to the college to provide the scholarship for the meritorious students hence according to the proposal above fund is deposited in term deposit scheme. With interest of that fund the scholarship is disbursed to the meritorious students every year.

5.1.3 What percentage of students receives financial assistance from state government, central government and other national agencies?

- State Government provides financial assistance to the students belonging to SC/ST, OBC, Minority and General also and this is about 62 % of the total strength.

5.1.4 What are the specific support services/facilities available for

- ✓ Students from SC/ST, OBC and economically weaker sections -
- ✓ Students with physical disabilities -
- ✓ Overseas students -
- ✓ Students to participate in various competitions/National and International-
- ✓ Medical assistance to students: health centre, health insurance etc. -
- ✓ Organizing coaching classes for competitive exams -√
- ✓ Skill development (spoken English, computer literacy, etc.,)

-√

- ✓ Support for “slow learners” -√
- ✓ Exposures of students to other institution of higher learning/ corporate/business house etc. -√
- ✓ Publication of student magazines -√

5.1.5 Describe the efforts made by the institution to facilitate entrepreneurial skills, among the students and the impact of the efforts.

- The coaching classes for weaker section particularly SC students are conducted to accelerate the entrepreneurial skills.

5.1.6 Enumerate the policies and strategies of the institution which promote participation of students in extracurricular and co-curricular activities such as sports, games, Quiz competitions, debate and discussions, cultural activities etc.

- * Additional academic support, flexibility in examinations
- * Special dietary requirements, sports uniform and materials
- * Any other

- The institution promotes the students for participation in extra-curricular activities by providing sports uniform, shoes and sport materials.

5.1.7 Enumerating on the support and guidance provided to the students in preparing for the competitive exams, give details on the number of students appeared and qualified in various competitive exams such as UGC-CSIR- NET, UGC-NET, SLET, ATE / CAT / GRE / TOFEL / GMAT / Central /State services, Defense, Civil Services, etc.

- UGC 01
- Central Services 02
- State Services 25
- Defence 30

5.1.8 What type of counseling services are made available to the students (academic, personal, career, psycho-social etc.)

- Career counseling and academic guidance are provided to the students by the faculty.

5.1.9 Does the institution have a structured mechanism for career guidance and placement of its students? If ‘yes’, detail on the services provided to help students identify job opportunities and prepare themselves for interview and the percentage of students selected during campus interviews by different employers (list the employers and the programs).

- Career guidance cell is already established for identifying job opportunities.

5.1.10 Does the institution have a student grievance redressal cell? If yes, list (if any) the grievances reported and redressed during the last four years.

- Grievance redressal cell is already framed to redress the grievances of the students.

5.1.11 What are the institutional provisions for resolving issues pertaining to sexual harassment?

- The proctorial board is already established to resolve the issues pertaining to sexual harassment but no case of this type has come to the knowledge of the institution till date.

5.1.12 Is there an anti-ragging committee? How many instances (if any) have been reported during the last four years and what action has been taken on these?

- Ragging free campus.

Anti-ragging Committee

- Boys

- | | | | |
|------|-------------------|---|----------|
| i. | Dr.V.K.Mishra | - | Convener |
| ii. | Dr.Anil Kumar | - | Members |
| iii. | Dr. Vishnu Mishra | - | Members |

Anti-ragging Committee

- Girls

- | | | | |
|------|------------------|---|----------|
| i. | Dr.Ranjana Sinha | - | Convener |
| ii. | Dr.Sadhana Gupta | - | Members |
| iii. | Savita Rajan | - | Members |

5.1.13 Enumerate the welfare schemes made available to students by the institution.

- Due to government institution the scheme like scholarship to the weaker section meritorious student are made available.

5.1.14 Does the institution have a registered Alumni Association? If 'yes', what are its activities and major contributions for institutional, academic and infrastructure development?

- The institution has non-registered alumni association which gives its suggestion for academic improvement.

5.2 Student Progression

5.2.1 Providing the percentage of students progressing to higher education or employment (for the last four batches) highlight the trends observed.

Student progression	%
UG to PG	10
PG to M.Phil.	Nil
PG to Ph.D.	Nil
Employed	
• Campus selection	No
• Other than campus recruitment	No

5.2.2 Provide details of the program wise pass percentage and completion rate for the last four years (cohort wise/batch wise as stipulated by the university)? Furnish program-wise details in comparison with that of the previous performance of the same institution and that of the Colleges of the affiliating university within the city/district.

- Details of the program wise pass percentage -2008

S.No.	Class	No. of students Appeared	No. of Students Passed	Pass Percentage
1	B.A-I	773	702	91
2	B.A-II	513	454	89
3	B.A-III	471	457	97
4	B.COM-I	62	43	70
5	B.COM-II	29	18	64
6	B.COM-III	23	14	64
7	B.Sc-I	159	98	62
8	B.Sc-II	67	52	78
9	B.Sc-III	46	36	78
10	M.A-I (soc)	61	53	87
11	M.A-II (soc)	53	50	94
12	M.A-I (Hindi)	61	55	90
13	M.A-II (Hindi)	76	67	88
14	M.A-I (Eco)	56	46	82
15	M.A-II (Eco)	18	17	94

- Details of the program wise pass percentage **2009**

S.No.	Class	No. of students Appeared	No. of Students Passed	Pass Percentage
1	B.A-I	486	453	93
2	B.A-II	722	680	94
3	B.A-III	482	473	98
4	B.COM-I	80	56	70
5	B.COM-II	41	39	95
6	B.COM-III	20	15	75
7	B.Sc-I	129	77	60
8	B.Sc-II	75	51	68
9	B.Sc-III	56	38	68
10	M.A-I (soc)	61	55	90
11	M.A-II (soc)	55	54	98
12	M.A-I (Hindi)	62	57	92
13	M.A-II (Hindi)	56	54	96
14	M.A-I (Eco)	67	63	94
15	M.A-II (Eco)	44	43	98

- Details of the program wise pass percentage **2010**

S.No.	Class	No. of students Appeared	No. of Students Passed	Pass Percentage
1	B.A-I	531	495	93
2	B.A-II	457	440	96
3	B.A-III	692	608	88
4	B.COM-I	78	50	64
5	B.COM-II	40	25	63
6	B.COM-III	50	30	60
7	B.Sc-I	144	89	62
8	B.Sc-II	61	43	70
9	B.Sc-III	57	30	53
10	M.A-I (soc)	46	33	71
11	M.A-II (soc)	51	48	94
12	M.A-I (Hindi)	62	54	87
13	M.A-II (Hindi)	56	55	98
14	M.A-I (Eco)	60	59	98
15	M.A-II (Eco)	61	53	87

- Details of the program wise pass percentage **2011**

S.No.	Class	No. of students Appeared	No. of Students Passed	Pass Percentage
1	B.A-I	445	361	81
2	B.A-II	490	435	89
3	B.A-III	478	433	91
4	B.COM-I	54	35	65
5	B.COM-II	47	30	64
6	B.COM-III	32	26	81
7	B.Sc-I	91	58	64
8	B.Sc-II	70	42	60
9	B.Sc-III	62	38	64
10	M.A-I (soc)	59	53	89
11	M.A-II (soc)	55	47	85
12	M.A-I (Hindi)	53	49	92
13	M.A-II (Hindi)	60	57	95
14	M.A-I (Eco)	64	35	54
15	M.A-II (Eco)	33	26	78

5.2.3 How does the institution facilitate student progression to higher level of education and/or towards employment?

- The institution facilitates student progression to higher level i.e. UG to PG, for employment opportunity by way of career guidance and interaction with the students.

5.2.3 Enumerate the special support provided to students who are at risk of failure and drop out?

- Tutorial classes are conducted for weak students.

5.3 Student Participation and Activities

5.3.1 List the range of sports, games, cultural and other extracurricular activities available to students. Provide details of participation and program calendar.

Program Organized by Sports Department.

{ Session 2009-10 }

- Session started with registration of Students in Sport Departments
- Selection of College Team of Athletics Volleyball and Cricket through trial was organized between 6 to 14 October
- From 27-10-2009 practice session of Athletes cricketers, Chess, Table tennis and Volleyball Student is held every day (except holiday) from 2.00 pm to 4.00 pm.
- First Indoor Game was organized in college on 14, 15 and 16 December 2009.
- 19th Annual Sports competition of college was organized on 21st and 22nd January 2010
- Annual Function of college was held on 18th Feb 2010.

Program Organized by Sports Department

{Session 2010-11}

- Session started with Registration of students in Sports Department.
- Trial was organized on 13th September 2010 for Inter-Collegiate Chess competition.
- Trial of College's Cricket Team for Inter-Collegiate completion was organized on 15th October 2010
- Trial for Athletics competition was organized 30 October 2010.
- Second Indoor Game was organized in the college on 25, 26 and 27th November 2010.
- **28th Annual Sports** competition was organized on 21st and 22nd December 2010.

- Annual Function of College was held on 4th March 2011. Chief Guest of the Function was Mrs. Rakesh Pushkar, Additional Superintendent of Police, Unnao (U.P.)

- Name of Students who participated Inter-Collegiate Chess competition organized college by P.P.N. College Kanpur (U.P.)

1. Muzzamil Ahmad M.A. II
2. Shobhit Singh B.A. II
3. Himanshu Bajapayi B.A. II
4. Amit Kumar B.Sc.I

- Name of students who participated in inter-collegiate Table Tennis competition organized in Brahmanand College Kanpur (U.P.)

1. Mann Singh B.Sc. II
2. Aditya Shukla B.Sc. II
3. Mohd. Shahid B.A. II

Programme Organized by Sports Department

(Session 2011-12)

- Session started with Registration of students in Sports Department.
- Trial was organized on 14th October 2011 for Inter- Collegiate Chess competition.
- Faculty Cricket Tournament was organized by Sports Department 3rd and 9th November 2011.
- Trial of Athletics team for Inter – Collegiate competition was organized from 15th to 17th November 2011.
- Third Indoor Game of College was organized on 10, 11 and 12th January 2012.
- 21st Annual Sports competition was organized on 19, 20 and 21st January 2012.

➤ Annual Function of college was held on 3rd March 2012. The Chief Guest of function was Mrs. Neha Sharma, Joint Magistrate, Unnao (U.P.)

➤ Name of the Students who participated in Inter-Collegiate Chess competition organized by P.P.N College Kanpur, (U.P.)

1. Surendra Kumar - B.Sc-II
2. Aditya Shukla - B.Sc-III
3. Satyam Mishra - B.Sc-II
4. Alok Shukla - B.Sc-II
5. Amit Kumar - B.Sc-II

➤ Name of the Student who participated in Inter-Collegiate Athletics competition organized by C.S.J.M University Kanpur, (U.P.)

1. Surendra Kumar - B.Sc-II
2. Amit Kumar - B.Sc-II
3. Narendra Kumar - B.A-I
4. Mayank Yadav - B.A-I
5. Ashok Kumar - B.A-I
6. Kanhaiya Lal - B.Sc-I
7. Abhishek Kumar - B.Sc-i
8. Radhey Shyam - M.A-I

5.3.2 Furnish the details of major student achievements in co-curricular, extracurricular and cultural activities at different levels: University / State / Zonal / National / International, etc. for the previous four years.

- No

5.3.3 How does the college seek and use data and feedback from its graduates and employers, to improve the performance and quality of the institutional provisions?

- The college seeks feed back from the graduates through Alumni Association meeting.
- 5.3.4 How does the college involve and encourage students to publish materials like catalogues, wall magazines, college magazine, and other material? List the publications materials brought out by the students during the previous four academic sessions.
- The college involves and encourages students to publish material in the college magazine every year.
- 5.3.5 Does the college have a Student Council or any similar body? Give details on its selection, constitution, activities and funding.
- The college has student council and the election of the student council is held in accordance with the Lingdoh Committee's recommendations. The student council co-ordinates the students and the college administration and the fund is generated from the fee collection.
- 5.3.6 Give details of various academic and administrative bodies that have student representatives on them.
- Games committee, Students welfare committee and Environmental conservation committee.
- 5.3.7 How does the institution network and collaborate with the Alumni and former faculty of the Institution.
- The standing committee of senior teachers has been formed to collaborate with the alumni association.

Any other relevant information regarding Student Support and Progression which the college would like to include.

- No

CRITERION VI: GOVERNANCE, LEADERSHIP AND MANAGEMENT

6.1 Institutional Vision and Leadership

- 6.1.1 State the vision and mission of the Institution and enumerate on how the mission statement defines the institution's distinctive characteristics in terms of addressing the needs of the society, the students it seeks to serve, institution's traditions and value orientations, vision for the future, etc.?

VISION

Indira Gandhi Govt. P. G. College Bangarmau, Unnao (U.P.) strives through sustained efforts to provide need based and skill oriented quality higher education to students from all sections of society for their overall personality development and inculcating moral values among them.

MISSION

- To achieve excellence in teaching, learning and research,
- To provide high quality, accessible, enriching education that prepares students for successful career
- Post Graduate education and lifelong learning in a multicultural global and technological society.
- Fostering and encouraging innovation and creativity.
- Communicate effectively in speech and writing.
- Think logically, analytically and creatively.
- Demonstrate mastery of an academic discipline.
- Integrate Moral values into their lives and create an atmosphere of mutual respect.
- Engage in the lifelong search for truth, beauty and justice.
- Create interest among the students for ecology and environment.

6.1.2 What is the role of top management, Principal and Faculty in design and implementation of its quality policy and plans?

- The different committees are formed regarding admission, discipline, game, co-curricular activities and examination to achieve excellence in teaching, enriching education and all around personality development of the students.

6.1.3 What is the involvement of the leadership in ensuring?

- the policy statements and action plans for fulfillment of the stated mission -√
- formulation of action plans for all operations and incorporation of the same into the institutional strategic plan -√
- Interaction with stakeholders -√
- Proper support for policy and planning through need analysis ,research inputs and consultations with the stakeholders -No
- Reinforcing the culture of excellence -√
- Champion organizational change -No

6.1.4 What are the procedures adopted by the institution to monitor and evaluate policies and plans of the institution for effective implementation and improvement from time to time?

- The steering committee is already formed to monitor and evaluate policies and plans of the institution for effective implementation of the mission of the college.

6.1.5 Give details of the academic leadership provided to the faculty by the top management?

- It is government institution headed by the Principal who provides academic freedom to faculty members for academic leadership.

6.1.6 How does the college groom leadership at various levels?

- Leadership of faculty members is developed through Teachers Association

6.1.7 How does the college delegate authority and provide operational autonomy to the departments / units of the institution and work towards decentralized governance system?

- The principal of the college delegates the powers and provides operational autonomy to each department's head for decentralized government system.

6.1.8 Does the college promote a culture of participative management? If 'yes', indicate the levels of participative management.

- Government Institution.

6.2 Strategy Development and Deployment

6.2.1 Does the Institution have a formally stated quality policy? How is it developed, driven, deployed and reviewed?

- The institution has a quality policy to achieve the mission and objectives of the college. The I.Q.A.C of the college is involved in developing, driving, deploying and reviewing quality policy.

6.2.2 Does the Institute have a perspective plan for development? If so, give the aspects considered for inclusion in the plan.

- The College makes persistence efforts to achieve its mission and objectives.

6.2.3 Describe the internal organizational structure and decision making processes.

- The Admission Committee
- College Development Committee
- Proctorial Board
- Grievance Redressal Cell
- Sports Advisory Board
- IQAC

Through these committees the internal organization completes decision making process.

6.2.4 Give a broad description of the quality improvement strategies of the institution for each of the following

- Teaching & Learning
- Research & Development

- Community engagement -Yes
- Human resource management
- Industry interaction -Yes

Following are

- Computer training, student feedback, teaching plan, Internet facility
- Minor projects in U.G.C., processing is going on.
- Orientation and Refresher courses.

6.2.5 How does the Head of the institution ensure that adequate information (from feedback and personal contacts etc.) is available for the top management and the stakeholders, to review the activities of the institution?

- Activities of the institution are communicated to higher authority by the Principal.

6.2.6 How does the management encourage and support involvement of the staff in improving the effectiveness and efficiency of the institutional processes?

- Government Institution.

6.2.7 Enumerate the resolutions made by the Management Council in the last year and the status of implementation of such resolutions.

- No.

6.2.8 Does the affiliating university make a provision for according the status of autonomy to an affiliated institution? If 'yes', what are the efforts made by the institution in obtaining autonomy?

- No.

6.2.9 How does the Institution ensure that grievances / complaints are promptly attended to and resolved effectively? Is there a mechanism to analyse the nature of grievances for promoting better stakeholder relationship?

- Each complaint is taken up by the Committee and the problem is resolved before the Principal.

Women's Grievances Cells

i.	Dr. Ranjana Sinha	-	Convener
ii.	Dr. Sadhana Gupta	-	Member
iii.	Savita	-	Member
iv.	Savita Rajan	-	Member
v.	Kiran	-	Member

6.2.10 During the last four years, had there been any instances of court cases filed by and against the institute? Provide details on the issues and decisions of the courts on these?

- No.

6.2.11 Does the Institution have a mechanism for analyzing student feedback on institutional performance? If 'yes', what was the outcome and response of the institution to such an effort?

- -Yes, after getting feedback, the Principal instructs the teachers about the problems and finding out a solution.

6.3 Faculty Empowerment Strategies

6.3.1 What are the efforts made by the institution to enhance the professional development of its teaching and non teaching staff?

- Orientation and Refresher courses, workshops, computer training programs are organized in which teachers of this College also participates as per the directions of the higher authority.

6.3.2 What are the strategies adopted by the institution for faculty empowerment through training, retraining and motivating the employees for the roles and responsibility they perform?

- Yes, Orientation, Refresher and Personality Development.

6.3.3 Provide details on the performance appraisal system of the staff to evaluate and ensure that information on multiple activities is appropriately captured and considered for better appraisal.

- Yes, Feedback from students and parents.

6.3.4 What is the outcome of the review of the performance appraisal reports by the management and the major decisions taken? How are they communicated to the appropriate stakeholders?

- Government institution.

6.3.5 What are the welfare schemes available for teaching and non teaching staff? What percentage of staff have availed the benefit of such schemes in the last four years?

- The financial aid for uniform of non-teaching staff is provided by the Government.

6.3.6 What are the measures taken by the Institution for attracting and retaining eminent faculty?

- Government Institution.

6.4 Financial Management and Resource Mobilization

6.4.1 What is the institutional mechanism to monitor effective and efficient use of available financial resources?

- A committee is formed to monitor effective and efficient use of available financial resources for betterment of infrastructural, academic and administrative mechanism.

6.4.2 What are the institutional mechanisms for internal and external audit? When was the last audit done and what are the major audit objections? Provide the details on compliance.

- The External Auditors from Accountant General Office Allahabad come for audit of the institution time to time. The recent audit was done on 19-01-2012 to 21-01-2012. There were no major audit objections in the audit report.

6.4.3 What are the major sources of institutional receipts/funding and how is the deficit managed? Provide audited income and expenditure statement of academic and administrative activities of the previous four years and the reserve fund/corpus available with Institutions, if any.

- Being a Government Institution receipts/funding is made by the State Government and the UGC. Utilization certificate of income and expenditure statements of academic and administrative activities are present.

6.4.4 Give details on the efforts made by the institution in securing additional funding and the utilization of the same (if any).

- No.

6.5 Internal Quality Assurance System (IQAS)

6.5.1 Internal Quality Assurance Cell (IQAC)

- Has the institution established an Internal Quality Assurance Cell (IQAC)? If 'yes', what is the institutional policy with regard to quality assurance and how has it contributed in institutionalizing the quality assurance processes?
 - Yes, The IQAC is already established to achieve excellence in teaching learning and research for student's empowerment through quality education.
- How many decisions of the IQAC have been approved by the management/ authorities for implementation and how many of them were actually implemented?
 - The regular meetings of IQAC are held to achieve the above goal and being enforced upon the teachers for implementation of decisions taken by IQAC. About 80% decisions have been implemented till date and rest are in progress.
- Does the IQAC have external members on its committee? If so, mention any significant contribution made by them.
 - No, There is no external member in IQAC
- How do students and alumni contribute to the effective functioning of the IQAC?
 - The feedback is taken from students and alumni association for effective functioning of IQAC and to enrich the quality of institutional practices.

e. How does the IQAC communicate and engage staff from different constituents of the institution?

- The IQAC communicate to the teachers and ministerial staff through regular meetings.

6.5.2 Does the institution have an integrated framework for Quality assurance of the academic and administrative activities? If 'yes', give details on its operationalisation.

- Yes, Anti ragging committee, Grievance Cell Redressal Cell, Women Cell, Academic and research committee are prominent supporters to improve the quality of academic and administrative activities.

6.5.3 Does the institution provide training to its staff for effective implementation of the Quality assurance procedures? If 'yes', give details enumerating its impact.

- No.

6.5.4 Does the institution undertake Academic Audit or other external review of the academic provisions? If 'yes', how are the outcomes used to improve the institutional activities?

- No.

6.5.5 How are the internal quality assurance mechanisms aligned with the requirements of the relevant external quality assurance agencies/regulatory authorities?

- The Institution coordinates with Higher Education Department, U.P Affiliated University and Higher Education Council for quality improvement.

6.5.6 What institutional mechanisms are in place to continuously review the teaching learning process? Give details of its structure, methodologies of operations and outcome?

- The high officials of the Higher Education Department inspect the institutional mechanisms to review academic and administrative activities.

6.5.7 How does the institution communicate its quality assurance policies, mechanisms and
Manual for Self-Study - Affiliated Colleges

outcomes to the various internal and external stakeholders?

- The Institution communicates its quality insurance policy mechanism and outcomes through the meetings.

Any other relevant information regarding Governance Leadership and Management which the college would like to include.

- No.

CRITERIA VII: INNOVATIONS AND BEST PRACTICES

7.1 Environment Consciousness

7.1.1 Does the Institute conduct a Green Audit of its campus and facilities?

- The committee is already formed to make the campus green.

7.1.2 What are the initiatives taken by the college to make the campus eco-friendly?

- | | |
|---------------------------------|------|
| * Energy conservation | -No |
| * Use of renewable energy | -No |
| * Water harvesting | -Yes |
| * Check dam construction | -No |
| * Efforts for Carbon neutrality | -No |
| * Plantation | -Yes |
| * Hazardous waste management | -Yes |
| * e-waste management | -No |

7.2 Innovations

7.2.1 Give details of innovations introduced during the last four years which have created a positive impact on the functioning of the college.

- The Innovative practices are
 - (i) Alumni Association
 - (ii) Teacher Parents Association
 - (iii) Students feedback
 - (iv) Parents feedback
 - (v) Research Project

- (vi) Environmental Management
- (vii) E-learning
- (viii) Computer training

7.3 Best Practices

7.3.1 Elaborate on any two best practices **as per the annexed format (see page ..)**

Which have contributed to the achievement of the Institutional Objectives and/or contributed to the Quality improvement of the core activities of the college?

Two best practices adopted by the Institution are **copy free examinations** and **increased use of projectors, computers and internet** to enrich the teaching-learning process.

Evaluative Report of the Departments

Botany

The Self-evaluation of every department may be provided separately in about 3-4 pages, avoiding the repetition of the data.

1. Name of the department- Department of Botany
2. Year of Establishment- 1996 (UG)
3. Names of Programs / Courses offered (UG, PG, M.Phil., Ph.D., Integrated Masters; Integrated Ph.D., etc.) U.G. (B.Sc. I, B.Sc. II, & B.Sc. III)
4. Names of Interdisciplinary courses and the departments/units involved **x**
5. Annual/ semester/choice based credit system (program wise) Annual
6. Participation of the department in the courses offered by other departments **x**
7. Courses in collaboration with other universities, industries, foreign institutions, etc. **x**
8. Details of courses/programs discontinued (if any) with reasons **x**
9. Number of Teaching posts

	sanctioned	Filled
Professors	-	-
Associate Professors	01	01
Asst. Professors	-	-

10. Faculty profile with name, qualification, designation, specialization, (D.Sc./D.Litt. /Ph.D. / M. Phil. etc.,)

Name	Qualification	Designation	Specialization	No. of Years of Experience	No. of Ph.D. Students guided for the last 4 years
Dr. D.S. Sachan	M. Sc., Ph. D	Associate Professor	Biotechnology	20	Nil

11. List of senior visiting faculty -No
12. Percentage of lectures delivered and practical classes handled(program wise) by temporary faculty -No
13. Student -Teacher Ratio (program wise) -1:60
14. Number of academic support staff (technical) and administrative staff; sanctioned and Filled- x
15. Qualifications of teaching faculty with DSc/ D.Litt/ Ph.D/ MPhil/PG. -P.G. ,Ph. D.
16. Number of faculty with ongoing projects from a) National b) International funding agencies and grants received -No
17. Departmental projects funded by DST-FIST; UGC, DBT, ICSSR, etc. and total grants received- -No
18. Research Centre /facility recognized by the University -Nil
19. Publications:

* a) Publication per faculty

1. "Isolation Of A Histidine Mutant Of The Cyanophyte Nostoc Linckia"
Proceeding of the symposium on Genetics Applied to Human Needs
 Bhabha Atomic Research Centre Bombay, January 10-11, 1977.
Dr.D.S. Sachan and H.D. Kumar

2. "Protective Effect of Amino Acids On Ultraviolet- Irradiated Nostoc Linckia"
Current Trends In Life Sciences:Vol,9-1981, L.P. Mall's Commemoration
Volume (pp.17-21)
Dr.D.S. Sachan and H.D. Kumar

3. "The Effects Of Some Amino Acids On Different Strains Of The Cyanophyte Nostoc Linckia"
Indian J.Bot. 4 (2). 236-239, Rec. Adv. Pl. Sci.,1981.
Dr.D.S. Sachan and H.D. Kumar

4. "Isolation And Characterization Of Mutants Of *Nostoc Linckia*"
India bot. Soc., 61: 59-72, 1982.
Dr.D.S. Sachan and H.D. Kumar
5. "Role Of Cyanobacteria In Artificial Creation Of Atmosphere in Other Planets Of Our Solar System And The Use Of Green Algae As Food In Space Travel"
All India Applied Phycological, Congress, Kanpur 1993
Dr.D.S. Sachan and H.D. Kumar
6. "Some Speculations Concerning The Primitive Atmosphere Of The Earth. The Planetary Atmospheres and the Possible Significance Of Cyanobacteria In The Atmospheric Evolution."
Workshop on Evolution of Earths Atmosphere over Geological Times Programme & Abstracts February 7-9, 1983 [Bhabha Atomic Research Centre]
Dr.D.S. Sachan and H.D. Kumar
7. "Spirulina-A Natural Package Of Super Nutrition"
The Journal Of The Indian Botanical Society,
Fouteenth All India Botanical Conference December 28-30, 1991,
Dr.D.S. Sachan
8. "Ecological Cultivation Of Super-Nutrient Alga *Spirulina*"
Saarc Countries Conference On Environment Management In Developing Countries. Organized By: Feroze Gandhi College Rae-Bareilly, India February 23-24, 1991.
Dr.D.S. Sachan
9. "Cultivation Of Spirulina In clean water In the rural habitats of Uttar Pradesh"
Spirulina Etta National Symposium (Etta: Ecology, Taxonomy, Technology & Applications) 30th September to 2nd October, 1991.
Dr.D.S. Sachan

10. “Biotechnology Of Cyanobacterium Spirulina “(A Controlled Ecological Life Support System)

National Conference On Environmental Conservation Sustainable Development and Industrial Expansion In 21st Century.

- * Number of papers published in peer reviewed journals (national/ international) by faculty and students - No
 - * Number of publications listed in International Database (For Eg: Web of Science, Scopus, Humanities International Complete, Dare Database - International Social Sciences Directory, EBSCO host, etc.) -No
 - * Monographs -No
 - * Chapter in Books -No
 - * Books Edited -No
 - * Books with ISBN/ISSN numbers with details of publishers -No
 - * Citation Index -No
 - * SNIP -No
 - * SJR -No
 - * Impact factor -No
 - * h-index -No
20. Areas of consultancy and income generated -No
21. Faculty as members in
- a) National committees b) International Committees c) Editorial Boards....
 - (i) Membership of UP Govt. Colleges Academic Society.
22. Student projects

- a) Percentage of students who have done in-house projects including inter departmental/program -100 %
- b) Percentage of students placed for projects in organizations outside the institution i.e.in Research laboratories/Industry/other agencies -No
23. Awards/ Recognitions received by faculty and students -No
24. List of eminent academicians and scientists/ visitors to the department -No
25. Seminars/ Conferences/Workshops organized & the source of funding
- a)National -No
- b) International -No
26. Student profile program/course wise:

Name of the Course/program (refer question no. 4)	Applications received	Selected	Enrolled		Pass percentage
			*M	*F	
B.Sc.-I	57	57	35. 22		24.5
B. Sc.-II	41	41	16. 25		56
B. Sc.-III	21	21	13. 08		71

*M=Male F=Female

27. Diversity of Students

Name of the Course	% of students from the same state	% of students from other States	% of students from abroad
UG	100	X	X
-	-	-	-
-	-	-	-
-	-	-	-

28. How many students have cleared national and state competitive examinations such as NET, SLET, GATE, Civil services, Defense services, etc. ? -10

29. Student progression

Student progression	Against % enrolled
UG to PG	x
PG to M.Phil.	x
PG to Ph.D.	x
Ph.D. to Post-Doctoral	x
Employed	
• Campus selection	x
• Other than campus recruitment	x
Entrepreneurship/Self-employment	35

30. Details of Infrastructural facilities

- a) Library -Yes
- b) Internet facilities for Staff & Students -Yes
- c) Class rooms with ICT facility -Yes
- d) Laboratories: - . -Yes

31. Number of students receiving financial assistance from college, university, government or other agencies:- -SC/ST, OBC, Minority and General Students receiving the scholarship from state govt.

32. Details on student enrichment programs (special lectures / workshops / seminar) with external experts: - -Special lecture proposed.

33. Teaching methods adopted to improve student learning: -Student interaction and lectures.

34. Participation in Institutional Social Responsibility (ISR) and Extension activities:-

- Separate sheet attached herewith.

35. SWOC analysis of the department and Future plans

- S. E-learning
- W. Work overload
- O. To prepare the students for research, lectureship, forest services, wild life conservation related organization, Scientist etc
- C. To motivate the students for the fulfillment of mission of department.
- Excursion to National Park/Zoo
- Development of Departmental of Library.
- To organize some workshop related to pollution controlling measures, AIDS, Environment Management etc.

Evaluative Report of the Departments

Zoology

The Self-evaluation of every department may be provided separately in about 3-4 pages, avoiding the repetition of the data.

1. Name of the department- Department of Zoology
2. Year of Establishment- 1996 (UG)
3. Names of Programs / Courses offered (UG, PG, M.Phil., Ph.D., Integrated Masters; Integrated Ph.D., etc.) U.G. (B.Sc.I, B.Sc.II, & B.Sc.III)
4. Names of Interdisciplinary courses and the departments/units involved **x**
5. Annual/ semester/choice based credit system (program wise) Annual
6. Participation of the department in the courses offered by other departments **x**
7. Courses in collaboration with other universities, industries, foreign institutions, etc. **x**
8. Details of courses/programs discontinued (if any) with reasons **x**
9. Number of Teaching posts

	sanctioned	Filled
Professors	-	-
Associate Professors	-	-
Asst. Professors	01	01

10. Faculty profile with name, qualification, designation, specialization, (D.Sc./D.Litt. /Ph.D. / M. Phil. etc.,)

Name	Qualification	Designation	Specialization	No. of Years of Experience	No. of Ph.D. Students guided for the last 4 years
Dr. Sadhana Gupta	M. Sc., Ph. D.	Assistant Professor	PARASITOLOGY	6	Nil

11. List of senior visiting faculty -No
12. Percentage of lectures delivered and practical classes handled(program wise) by temporary faculty -No
13. Student -Teacher Ratio (program wise) -1:60
14. Number of academic support staff (technical) and administrative staff; sanctioned and Filled- x
15. Qualifications of teaching faculty with DSc/ D.Litt/ Ph.D/ MPhil/PG. -P.G. ,Ph.D
16. Number of faculty with ongoing projects from a) National b) International funding agencies and grants received -No
17. Departmental projects funded by DST-FIST; UGC, DBT, ICSSR, etc. and total grants received- Project proposal has been sent to U.G.C. for acceptance & financial assistance.
18. Research Centre /facility recognized by the University -Nil
19. Publications:
- * a) Publication per faculty
1. "Procamallanus (Procamallanus) Lucknowensis N. Sp. (Nematoda: Camallanidae) from Small Intestine of fresh Water Fish, Heteropneustes Fossilis (Bi) From Lucknow".
Proceeding of the Academy of Environmental Biology 2002.
Sadhana Gupta
 2. "Abstract on Heliconema Mastacembeli n.sp. (Nematoda: Physaloptesidae) from the small intestine of a fresh water fish Mastacembelus Armalus from Lucknow"
Proceeding of Indian Science Congress Association 2002.
Sadhana Gupta

* Number of papers published in peer reviewed journals (national / international) by faculty and students	-x
* Number of publications listed in International Database (For Eg: Web of Science, Scopus, Humanities International Complete, Dare Database - International Social Sciences Directory, EBSCO host, etc.)	-x
* Monographs	-x
* Chapter in Books	-x
* Books Edited	-x
* Books with ISBN/ISSN numbers with details of publishers	-x
* Citation Index	-x
* SNIP	-x
* SJR	-x
* Impact factor	-x
* h-index	-x
20. Areas of consultancy and income generated	-No
21. Faculty as members in	
a) National committees b) International Committees c) Editorial Boards....	
(i) Membership of UP Govt. Colleges Academic Society.	
22. Student projects	
a) Percentage of students who have done in-house projects including inter departmental/program	-100 %
b) Percentage of students placed for projects in organizations outside the institution i.e.in Research laboratories/Industry/other agencies	-No
23. Awards/ Recognitions received by faculty and students	-NO

24. List of eminent academicians and scientists/ visitors to the department

- Visit of eminent academicians and scientist is proposed for guest lectures.

25. Seminars/ Conferences/Workshops organized & the source of funding

a)National -No

b) International -No

26. Student profile program/course wise:

Name of the Course/program (refer question no. 4)	Applications received	Selected	Enrolled		Pass percentage
			*M	*F	
B.Sc.-I	57	57	35.	22	24.5
B. Sc.-II	41	41	16.	25	56
B. Sc.-III	21	21	13.	08	71

*M=Male F=Female

27. Diversity of Students

Name of the Course	% of students from the same state	% of students from other States	% of students from abroad
UG	100	X	X
-	-	-	-
-	-	-	-
-	-	-	-

28. How many students have cleared national and state competitive examinations such as NET, SLET, GATE, Civil services, Defense services, etc? -10

29. Student progression

Student progression	Against % enrolled
UG to PG	x
PG to M.Phil.	x
PG to Ph.D.	x
Ph.D. to Post-Doctoral	x
Employed	
• Campus selection	x
• Other than campus recruitment	x
Entrepreneurship/Self-employment	35

30. Details of Infrastructural facilities

- a) Library -Yes
- b) Internet facilities for Staff & Students -Yes
- c) Class rooms with ICT facility -Yes
- d) Laboratories: - . -Yes

31. Number of students receiving financial assistance from college, university, government or other agencies:- -SC/ST, OBC, Minority and General Students receiving the scholarship from state govt.

32. Details on student enrichment programs (special lectures / workshops / seminar) with external experts :- -Special lecture proposed.

33. Teaching methods adopted to improve student learning: -Student interaction and lectures.

34. Participation in Institutional Social Responsibility (ISR) and Extension activities:-

- Separate sheet attached herewith.

35. SWOC analysis of the department and Future plans

- S. E-learning
- W. Work overload
- O. To prepare the students for research, lectureship, forest services, wild life conservation related organization, Scientist etc
- C. To motivate the students for the fulfillment of mission of department.
- Excursion to National Park/Zoo
- Development of Departmental of Libaray.
- To organize some workshop related to pollution controlling measures, AIDS, Environment Management etc.

Evaluative Report of the Departments

Mathematics

The Self-evaluation of every department may be provided separately in about 3-4 pages, avoiding the repetition of the data.

1. Name of the department- Department of Mathematics
2. Year of Establishment- 1996 (UG)
3. Names of Programs / Courses offered (UG, PG, M. Phil., Ph.D., Integrated Masters; Integrated Ph.D., etc.) U.G. (B.Sc. I, B.Sc. II, & B.Sc. III)
4. Names of Interdisciplinary courses and the departments/units involved **No**
5. Annual/ semester/choice based credit system (program wise) -Annual
6. Participation of the department in the courses offered by other departments -No
7. Courses in collaboration with other universities, industries, foreign institutions, etc. -No
8. Details of courses/programs discontinued (if any) with reasons -No
9. Number of Teaching posts

	Sanctioned	Filled
Professors	-	-
Associate Professors	01	01
Asst. Professors	-	-

10. Faculty profile with name, qualification, designation, specialization, (D.Sc./D.Litt. /Ph.D. / M. Phil. etc.,)

Name	Qualification	Designation	Specialization	No. of Years of Experience	No. of Ph.D. Students guided for the last 4 years
Dr. Anil Kumar	M.A, Ph. D	Associate Professor	FLUID DYNAMICS	14	Nil

11. List of senior visiting faculty -No
12. Percentage of lectures delivered and practical classes handled(program wise) by temporary faculty -No
13. Student -Teacher Ratio (program wise) -1:60
14. Number of academic support staff (technical) and administrative staff; sanctioned and Filled- **x**
15. Qualifications of teaching faculty with DSc/ D. Litt/ Ph. D/ M Phil/PG. -P.G. ,Ph .D
16. Number of faculty with ongoing projects from a) National b) International funding agencies and grants received -No
17. Departmental projects funded by DST-FIST; UGC, DBT, ICSSR, etc. and total grants received- -No
18. Research Centre /facility recognized by the University -Nil
19. Publications:

* a) Publication per faculty

1. “Mass Transfer Effects On *MHD* Natural Convection Flow”

[Proc. Math. Soc. B.H.U. Vol.4 (1988)]

Basant Kumar Jha and Anil Kumar

2. “Asymptotic Behaviours Of The Solutions Of MFD Boundary Layer Flow On a Moving Continuous Flat Surface”

[Journal Of Hunan University, 1989, Vol.16, No.1]

B.B. Singh and Anil Kumar

3. “Flow Of a Second Order Fluid Due to the Rotation Of An Infinite Porous Disk Near A Stationary Parallel Porous Disk”

[Indian J.pure appl. Math. 20(9): 931-943. September 1989]

B.B. Singh and Anil Kumar

4. "On The Asymptotic Behaviour Of Boundary Layer Blow Off"

[Proc. Indian Natn.Sci.Acad.56, A, No.4, 1990, pp. 361-366]

J. Singh, B.B. Singh and Anil Kumar

5. "Some Aspects Related To The Asymptotic Solutions Of the Laminar Boundary-Layer Equations With Heat Flux

[Astrophysics and Space Science 165: 41-49, 1990]

Anil Kumar and B.B. Singh

- * Number of papers published in peer reviewed journals (national / international) by faculty and students -No
- * Number of publications listed in International Database (For e.g. : Web of Science, Scopus, Humanities International Complete, Dare Database - International Social Sciences Directory, EBSCO host, etc.) -No
- * Monographs -No
- * Chapter in Books -No
- * Books Edited -No
- * Books with ISBN/ISSN numbers with details of publishers -No
- * Citation Index -No
- * SNIP -No
- * SJR -No
- * Impact factor -No
- * h-index -No

20. Areas of consultancy and income generated -No

21. Faculty as members in

a) National committees b) International Committees c) Editorial Boards....

(i) Membership of UP Govt. Colleges Academic Society.

22. Student projects

a) Percentage of students who have done in-house projects including inter departmental/program -100 %

b) Percentage of students placed for projects in organizations outside the institution i.e.in Research laboratories/Industry/other agencies -No

23. Awards/ Recognitions received by faculty and students -NO

24. List of eminent academicians and scientists/ visitors to the department

- Visit of eminent academicians and scientist is proposed for guest lectures.

25. Seminars/ Conferences/Workshops organized & the source of funding

a)National -No

b) International -No

26. Student profile program/course wise:

Name of the Course/program (refer question no. 4)	Applications received	Selected	Enrolled		Pass percentage
			*M	*F	
B.Sc.-I	53	34	27	7	49
B. Sc.-II	27	27	22	5	61
B. Sc.-III	22	22	16	6	67

*M=Male F=Female

27. Diversity of Students

Name of the Course	% of students from the same state	% of students from other States	% of students from abroad
UG	100	X	X
-	-	-	-
-	-	-	-
-	-	-	-

28. How many students have cleared national and state competitive examinations such as NET, SLET, GATE, Civil services, Defense services, etc. ? -10

29. Student progression

Student progression	Against % enrolled
UG to PG	x
PG to M. Phil.	x
PG to Ph.D.	x
Ph.D. to Post-Doctoral	x
Employed	
• Campus selection	x
• Other than campus recruitment	x
Entrepreneurship/Self-employment	35

30. Details of Infrastructural facilities

- a) Library -Yes
- b) Internet facilities for Staff & Students -Yes
- c) Class rooms with ICT facility -Yes
- d) Laboratories :- (Computer Lab) . -Yes

31. Number of students receiving financial assistance from college, university, government or other agencies:- -SC/ST, OBC, Minority and General Students receiving the scholarship from state govt.

32. Details on student enrichment programs (special lectures / workshops / seminar) with external experts: - -Special lecture proposed.
33. Teaching methods adopted to improve student learning: -Student interaction and lectures.
34. Participation in Institutional Social Responsibility (ISR) and Extension activities:-
- Separates sheet attached herewith.
35. SWOC analysis of the department and Future plans
- S. E-learning
- W. Work over load, faculty is not sufficient
- O. To prepare the students for research, lectureship, forest services, wild life conservation related organization, Scientist etc
- C. To motivate the students for the fulfillment of mission of department.
- Development of Departmental of Library.
- Organizing Guest lecture & seminar to progress the knowledge of subject to the students.

Evaluative Report of the Departments Physics

The Self-evaluation of every department may be provided separately in about 3-4 pages, avoiding the repetition of the data.

1. Name of the department- Department of Physics
2. Year of Establishment- 1996 (UG)
3. Names of Programs / Courses offered (UG, PG, M. Phil., Ph.D., Integrated Masters; Integrated Ph.D., etc.) U.G. (B.Sc. I, B.Sc. II, & B.Sc. III)
4. Names of Interdisciplinary courses and the departments/units involved **-No**
5. Annual/ semester/choice based credit system (program wise) Annual
6. Participation of the department in the courses offered by other departments **-No**
7. Courses in collaboration with other universities, industries, foreign institutions, etc. **-No**
8. Details of courses/programs discontinued (if any) with reasons **-No**
9. Number of Teaching posts

	sanctioned	Filled
Professors	-	-
Associate Professors	-	-
Asst. Professors	01	01

10. Faculty profile with name, qualification, designation, specialization, (D.Sc./D.Litt. /Ph.D. / M. Phil. etc.,)

Name	Qualification	Designation	Specialization	No. of Years of Experience	No. of Ph.D. Students guided for the last 4 years
Dr. Ashok Kumar	M. Sc., Ph. D.	Assistant Professor	LATICE DYNAMICS	12	Nil

11. List of senior visiting faculty -No
12. Percentage of lectures delivered and practical classes handled(program wise) by temporary faculty -No
13. Student -Teacher Ratio (program wise) -1:60
14. Number of academic support staff (technical) and administrative staff; sanctioned and filled- -No
15. Qualifications of teaching faculty with DSc/ D.Litt/ Ph.D/ MPhil/PG. -P.G. ,Ph. D.
16. Number of faculty with ongoing projects from a) National b) International funding agencies and grants received -No
17. Departmental projects funded by DST-FIST; UGC, DBT, ICSSR, etc. and total grants received- - No
18. Research Centre /facility recognized by the University -Nil
19. Publications:
- * a) Publication per faculty -NO
 - * Number of papers published in peer reviewed journals (national / international) by faculty and students -No
 - * Number of publications listed in International Database (For Eg: Web of Science, Scopus, Humanities International Complete, Dare Database - International Social Sciences Directory, EBSCO host, etc.) -No
 - * Monographs -No
 - * Chapter in Books -No
 - * Books Edited -No
 - * Books with ISBN/ISSN numbers with details of publishers -No
 - * Citation Index -No
 - * SNIP -No
 - * SJR -No
 - * Impact factor -No
 - * h-index -No
20. Areas of consultancy and income generated -No

21. Faculty as members in

a) National committees b) International Committees c) Editorial Boards....

(i) Membership of UP Govt. Colleges Academic Society.

(ii) Member of Academic Council Kashi Vidya Peeth Varanasi.

(iii) Member of Academic Council Bareilly University, Bareilly.

22. Student projects

a) Percentage of students who have done in-house projects including inter

departmental/program -100 %

b) Percentage of students placed for projects in organizations outside the institution i.e.in

Research laboratories/Industry/other agencies -No

23. Awards/ Recognitions received by faculty and students -NO

24. List of eminent academicians and scientists/ visitors to the department

- Visit of eminent academicians and scientist is proposed for guest lectures.

25. Seminars/ Conferences/Workshops organized & the source of funding

a) National -No

b) International -No

26. Student profile program/course wise:

Name of the Course/program (refer question no. 4)	Applications received	Selected	Enrolled		Pass percentage
			*M	*F	
B.Sc.-I	53	34	27	7	49
B. Sc.-II	27	27	22	5	61
B. Sc.-III	22	22	16	6	67

*M=Male F=Female

27. Diversity of Students

Name of the Course	% of students from the same state	% of students from other States	% of students from abroad
UG	100	X	X
-	-	-	-
-	-	-	-
-	-	-	-

28. How many students have cleared national and state competitive examinations such as NET, SLET, GATE, Civil services, Defense services, etc. ? -10

29. Student progression

Student progression	Against % enrolled
UG to PG	x
PG to M. Phil.	x
PG to Ph.D.	x
Ph.D. to Post-Doctoral	x
Employed	
• Campus selection	x
• Other than campus recruitment	x
Entrepreneurship/Self-employment	35

30. Details of Infrastructural facilities

- a) Library -Yes
- b) Internet facilities for Staff & Students -Yes
- c) Class rooms with ICT facility -Yes
- d) Laboratories: - . -Yes

31. Number of students receiving financial assistance from college, university, government or other agencies:- -SC/ST, OBC, Minority and General Students receiving the scholarship from state govt.

32. Details on student enrichment programs (special lectures / workshops / seminar) with external experts: - -Special lecture proposed.
33. Teaching methods adopted to improve student learning: -Student interaction and lectures.
34. Participation in Institutional Social Responsibility (ISR) and Extension activities:-
- Separate sheet attached herewith.
35. SWOC analysis of the department and Future plans
- S. E-learning
- W. Work overload
- O. To prepare the students for research, lectureship, forest services, wild life conservation related organization, Scientist etc
- C. To motivate the students for the fulfillment of mission of department.
- Development of Departmental of Library.
- Organizing Guest Lecture Strengthen the subject knowledge of students.

Evaluative Report of the Departments

History

The Self-evaluation of every department may be provided separately in about 3-4 pages, avoiding the repetition of the data.

1. Name of the department- Department of History
2. Year of Establishment- 1988
3. Names of Programs / Courses offered (UG, PG, M. Phil., Ph.D., Integrated Masters; Integrated Ph.D., etc.) U.G.
4. Names of Interdisciplinary courses and the departments/units involved -No
5. Annual/ semester/choice based credit system (program wise) Annual
6. Participation of the department in the courses offered by other departments -No
7. Courses in collaboration with other universities, industries, foreign institutions, etc. -No
8. Details of courses/programs discontinued (if any) with reasons -No

Number of Teaching posts

	sanctioned	Filled
Professors	-	-
Associate Professors	01	01
Asst. Professors	-	-

9. Faculty profile with name, qualification, designation, specialization, (D.Sc./D.Litt.

Name	Qualification	Designation	Specialization	No. of Years of Experience	No. of Ph.D. Students guided for the last 4 years
Dr. Ranjna Sinha	Ph.D	Associate Professor	Ancient Indian History and Archaeology	14	Nil

10. List of senior visiting faculty -No
11. Percentage of lectures delivered and practical classes handled(program wise) by temporary faculty -No
12. Student -Teacher Ratio (program wise) -150:1
13. Number of academic support staff (technical) and administrative staff; sanctioned and filled- x
14. Qualifications of teaching faculty with DSc/ D.Litt/ Ph.D/ MPhil/PG. - P.G., Ph.D.
15. Number of faculty with ongoing projects from a) National b) International funding agencies and grants received -Project Proposal in process
16. Departmental projects funded by DST-FIST; UGC, DBT, ICSSR, etc. and total grants received- -No
17. Research Centre /facility recognized by the University -Nil
18. Publications:
- * a) Publication per faculty -No
 - * Number of papers published in peer reviewed journals (national / international) by faculty and students -No
 - * Number of publications listed in International Database (For e.g.: Web of Science, Scopus, Humanities International Complete, Dare Database - International Social Sciences Directory, EBSCO host, etc.) -No
 - * Monographs -No
 - * Chapter in Books -No
 - * Books Edited -No
 - * Books with ISBN/ISSN numbers with details of publishers -No
 - * Citation Index -No
 - * SNIP -No
 - * SJR -No
 - * Impact factor -No
 - * h-index -No
19. Areas of consultancy and income generated -No

20. Faculty as members in

a) National committees b) International Committees c) Editorial Boards....

(i) Life Membership of Indian Archeological Society.

(ii) Life Member of society.

(iii) Membership of UP Govt. Colleges Academic Society.

21. Student projects

a) Percentage of students who have done in-house projects including inter departmental/program -No

b) Percentage of students placed for projects in organizations outside the institution i.e.in Research laboratories/Industry/other agencies -No

22. Awards/ Recognitions received by faculty and students

- Fellowship of ICHR (Indian Council of Historical Research)

23. List of eminent academicians and scientists/ visitors to the department -No

24. Seminars/ Conferences/Workshops organized & the source of funding

a)National -No

b)International -No

25. Student profile program/course wise:

Name of the Course/program (refer question no. 4)	Applications received	Selected	Enrolled		Pass percentage
			*M	*F	
B.A-I	350	330	57	273	98
B.A-II	388	388	82	306	90
B.A-III	453	453	138	315	95

*M=Male F=Female

26. Diversity of Students

Name of the Course	% of students from the same state	% of students from other States	% of students from abroad
UG	100	X	X
-	-	-	-
-	-	-	-
-	-	-	-

27. How many students have cleared national and state competitive examinations such as NET, SLET, GATE, Civil services, Defense services, etc? -No

28. Student progression

Student progression	Against % enrolled
UG to PG	x
PG to M. Phil.	x
PG to Ph.D.	x
Ph.D. to Post-Doctoral	x
Employed	
• Campus selection	x
• Other than campus recruitment	x
Entrepreneurship/Self-employment	10

29. Details of Infrastructural facilities

- a) Library -Yes
- b) Internet facilities for Staff & Students -Yes
- c) Class rooms with ICT facility -Yes
- d) Laboratories: - Computer lab is available for the students.

30. Number of students receiving financial assistance from college, university, government or other agencies: - SC/ST, OBC, Minority and General Students receiving the scholarship from state govt.

31. Details on student enrichment programs (special lectures / workshops / seminar) with external experts :- Special lecture proposed – Dr. Karuna Shankar Shukla

32. Teaching methods adopted to improve student learning:-

- By delivering extra lectures providing reading materials and Remedial classes

33. Participation in Institutional Social Responsibility (ISR) and Extension activities:- No

34. SWOC analysis of the department and Future plans

S. Free and fair examination, Computer learning program

W. Work over load

O. Job opportunities available in different fields like museum

C. To motivate the student to innovate new Historical fields and area.

Evaluative Report of the Departments Hindi

The Self-evaluation of every department may be provided separately in about 3-4 pages, avoiding the repetition of the data.

1. Name of the department- Department of Hindi
2. Year of Establishment- 1988 (UG) & 1998 (P.G.)
3. Names of Programs / Courses offered (UG, PG, M. Phil., Ph.D., Integrated Masters; Integrated Ph.D., etc.) U.G. (B.A.I, B.A.II & B.A.III) P.G. (M.A.-I, M.A.-II)
4. Names of Interdisciplinary courses and the departments/units involved **-No**
5. Annual/ semester/choice based credit system (program wise) Annual
6. Participation of the department in the courses offered by other departments **-No**
7. Courses in collaboration with other universities, industries, foreign institutions, etc. **-No**
8. Details of courses/programs discontinued (if any) with reasons **-No**
9. Number of Teaching posts

	sanctioned	Filled
Professors	-	-
Associate Professors	-	-
Asst. Professors	01	01

10. Faculty profile with name, qualification, designation, specialization, (D.Sc./D.Litt. /Ph.D. / M. Phil. etc.,)

Name	Qualification	Designation	Specialization	No. of Years of Experience	No. of Ph.D. Students guided for the last 4 years
Ashok Priyadarshi	M.A., D. Phil	Assistant Professor	KABIR DAS	06	NIL

11. List of senior visiting faculty -NO
12. Percentage of lectures delivered and practical classes handled(program wise) by temporary faculty -No
13. Student -Teacher Ratio (program wise) -1:120, In U.G. & 1:60 In P.G.
14. Number of academic support staff (technical) and administrative staff; sanctioned and Filled- No
15. Qualifications of teaching faculty with D. Sc/ D. Lit/ Ph. D/ M. Phil/PG. -M.A., D.Phil.
16. Number of faculty with ongoing projects from a) National b) International funding agencies and grants received -Project proposal in process
17. Departmental projects funded by DST-FIST; UGC, DBT, ICSSR, etc. and total grants received- -No
18. Research Centre /facility recognized by the University -Nil
19. Publications:
- * a) Publication per faculty
 - * Number of papers published in peer reviewed journals (national / international) by faculty and students -No
 - * Number of publications listed in International Database (For e.g.: Web of Science, Scopus, Humanities International Complete, Dare Database - International Social Sciences Directory, EBSCO host, etc.) -No
 - * Monographs -No
 - * Chapter in Books -No
 - * Books Edited -No
 - * Books with ISBN/ISSN numbers with details of publishers
 - * Citation Index -No
 - * SNIP -No
 - * SJR -No

- * Impact factor -No
- * h-index -No
- 20. Areas of consultancy and income generated -No
- 21. Faculty as members in
 - a) National committees b) International Committees c) Editorial Boards....
 - (i) Membership of UP Govt. Colleges Academic Society.
- 22. Student projects
 - a) Percentage of students who have done in-house projects including inter departmental/program -100 %
 - b) Percentage of students placed for projects in organizations outside the institution i.e.in Research laboratories/Industry/other agencies -No
- 23. Awards/ Recognitions received by faculty and students -No
- 24. List of eminent academicians and scientists/ visitors to the department -No
- 25. Seminars/ Conferences/Workshops organized & the source of funding
 - a) National -No
 - b) International -No

26. Student profile program/course wise:

Name of the Course/program (refer question no. 4)	Applications received	Selected	Enrolled		Pass percentage
			*M	*F	
(U.G.) B.A.I	475	408	82	326	86
B.A.II	318	318	64	254	94
B.A.III	252	252	74	168	96
(P.G.) M.A.-I	116	60	14	46	98
M.A.-II	54	54	10	44	99

*M=Male F=Female

27. Diversity of Students

Name of the Course	% of students from the same state	% of students from other States	% of students from abroad
U.G.	100	X	X
P.G	100	X	X
-	-	-	-
-	-	-	-

28. How many students have cleared national and state competitive examinations such as NET, SLET, GATE, Civil services, Defense services, etc. ? -10

29. Student progression

Student progression	Against % enrolled
UG to PG	100
PG to M.Phil.	x
PG to Ph.D.	x
Ph.D. to Post-Doctoral	x
Employed	
• Campus selection	x
• Other than campus recruitment	x
Entrepreneurship/Self-employment	15

30. Details of Infrastructural facilities

- a) Library -Yes
- b) Internet facilities for Staff & Students -Yes
- c) Class rooms with ICT facility -Yes
- d) Laboratories: - . -No

31. Number of students receiving financial assistance from college, university, government or other agencies:- -SC/ST, OBC, Minority and General Students receiving the scholarship from state govt.

32. Details on student enrichment program (special lectures / workshops / seminar) with external experts :- -Special lecture proposed

33. Teaching methods adopted to improve student learning: -Lectures, Student interaction & ICT

34. Participation in Institutional Social Responsibility (ISR) and Extension activities:-

- Participation in Polio Alleviation Program,
- Motivation of voters to strengthen democracy

Separates sheet attached herewith.

35. SWOC analysis of the department and Future plans

S. Free and fair examination, Computer learning program

W. Work load, teacher-student ratio is not sufficient

O. To prepare the student for job, civil services, teaching and self employment.

C. Motivate the student to word application of the subject

1. Social evil of society

2. Importance of individual family, Join family etc

➤ Visit the library,

➤ Social survey, visit the departmental library

➤ To knowledge about ancient poets and writers of the Hindi language.

Evaluative Report of the Departments

Physical Education

The Self-evaluation of every department may be provided separately in about 3-4 pages, avoiding the repetition of the data.

1. Name of the department- Department of Physical Education
2. Year of Establishment- 2012 (UG)
3. Names of Programs / Courses offered (UG, PG, M.Phil., Ph.D., Integrated Masters; Integrated Ph.D., etc.) U.G. (B.A./B.Sc.-I, B.A./B.Sc.II, & B.A./B.Sc.III)
4. Names of Interdisciplinary courses and the departments/units involved -No
5. Annual/ semester/choice based credit system (program wise) Annual
6. Participation of the department in the courses offered by other departments -No
7. Courses in collaboration with other universities, industries, foreign institutions, etc. -No
8. Details of courses/programs discontinued (if any) with reasons -No
9. Number of Teaching posts

	sanctioned	Filled
Professors	-	-
Associate Professors	-	-
Asst. Professors	01	01

10. Faculty profile with name, qualification, designation, specialization, (D.Sc./D.Litt. /Ph.D. / M. Phil. etc.,)

Name	Qualification	Designation	Specialization	No. of Years of Experience	No. of Ph.D. Students guided for the last 4 years
Dr. Vishnu Mishra	M.A., Ph.D	Assistant Professor	CRICKET	Three & Half year	01

11. List of senior visiting faculty	Dr. Gopal Krishan- HOD (L.C.D.C.Lucknow)
12. Percentage of lectures delivered and practical classes handled(program wise) by temporary faculty	-No
13. Student -Teacher Ratio (program wise)	-1:60
14. Number of academic support staff (technical) and administrative staff; sanctioned and filled-	No
15. Qualifications of teaching faculty with DSc/ D.Litt/ Ph.D/ MPhil/PG.	-P.G. ,Ph.D
16. Number of faculty with ongoing projects from a) National b) International funding agencies and grants received	-No
17. Departmental projects funded by DST-FIST; UGC, DBT, ICSSR, etc. and total grants received-	-No
18. Research Centre /facility recognized by the University	-Nil
19. Publications:	
* a) Publication per faculty	
1. “Assessment Of Aggression And Anxiety Among Players Of Selected Sports”	
[Indian Journal Of Sport Studies, Vol. 6, No.2 July-Dec 2001]	
Vishnu Mishra and Dr. Gopal Krishna	
* Number of papers published in peer reviewed journals (national / international) by faculty and students	-No
* Number of publications listed in International Database (For Eg: Web of Science, Scopus, Humanities International Complete, Dare Database - International Social Sciences Directory, EBSCO host, etc.)	-
* Monographs	-No
* Chapter in Books	-No
* Books Edited	-No

- * Books with ISBN/ISSN numbers with details of publishers
 - Principle of Physical Education and Sports Psychology- Vedant
Publication ISBN 81-906450-8-9
 - Anatomy and Physiology- Vedant Publication ISBN 819064504-1
- * Citation Index -No
- * SNIP -No
- * SJR -No
- * Impact factor -No
- * h-index -No

20. Areas of consultancy and income generated -No

21. Faculty as members in

a) National committees b) International Committees c) Editorial Boards....

(i) Membership of UP Govt. Colleges Academic Society.

(ii) Indian Society Sport Science- Life Member

(iii) Assessment of Aggression and Anxiety among Players of Selected Sports **Published**

By- Indian

Society of Sports Science

22. Student projects

a) Percentage of students who have done in-house projects including inter

departmental/program -100 %

b) Percentage of students placed for projects in organizations outside the institution i.e.in

Research laboratories/Industry/other agencies -No

23. Awards/ Recognitions received by faculty and students -NO

24. List of eminent academicians and scientists/ visitors to the department

- Visit of eminent academicians and scientist is proposed for guest lectures.

25. Seminars/ Conferences/Workshops organized & the source of funding

a)National -No

b) International -No

26. Student profile program/course wise:

Name of the Course/program (refer question no. 4)	Applications received	Selected	Enrolled		Pass percentage
			*M	*F	
B.A.I	47	24	18	06	

*M=Male F=Female

27. Diversity of Students

Name of the Course	% of students from the same state	% of students from other States	% of students from abroad
UG	100	X	X
-	-	-	-
-	-	-	-
-	-	-	-

28. How many students have cleared national and state competitive examinations such as NET, SLET, GATE, Civil services, Defense services, etc. ? -10

29. Student progression

Student progression	Against % enrolled
UG to PG	x
PG to M.Phil.	x
PG to Ph.D.	x
Ph.D. to Post-Doctoral	x
Employed	
• Campus selection	x
• Other than campus recruitment	x
Entrepreneurship/Self-employment	35

30. Details of Infrastructural facilities

- | | |
|---|------|
| a) Library | Yes |
| b) Internet facilities for Staff & Students | -Yes |
| c) Class rooms with ICT facility | -Yes |
| d) Laboratories: - | -No |

31. Number of students receiving financial assistance from college, university, government or other agencies:- -SC/ST, OBC, Minority and General Students receiving the scholarship from state govt.

32. Details on student enrichment programs (special lectures / workshops / seminar) with external experts: - -Special lecture proposed.

33. Teaching methods adopted to improve student learning: -Project Method and lectures.

34. Participation in Institutional Social Responsibility (ISR) and Extension activities:-

- Separate sheet attached herewith.

35. SWOC analysis of the department and Future plans

- S. Free and fair examination, Computer learning program
- W. Work over load
- O. Job opportunities available in different fields.
- C. To motivate the student to innovate new importance & aspect of game.
- Development of Departmental of Library.
- Participating in different collegiate and university level games competitions.

Evaluative Report of the Departments Economics

The Self-evaluation of every department may be provided separately in about 3-4 pages, avoiding the repetition of the data.

1. Name of the department- Department of Economics
2. Year of Establishment- 1988 (UG) & 1998 (P.G.)
3. Names of Programs / Courses offered (UG, PG, M.Phil., Ph.D., Integrated Masters; Integrated Ph.D., etc.) U.G. (B.A.I, B.A.II & B.A.III) & P.G. (M.A.I & M.A.II)
4. Names of Interdisciplinary courses and the departments/units involved **-No**
5. Annual/ semester/choice based credit system (program wise) Annual
6. Participation of the department in the courses offered by other departments **-No**
7. Courses in collaboration with other universities, industries, foreign institutions, etc. **-No**
8. Details of courses/programs discontinued (if any) with reasons **-No**
9. Number of Teaching posts

	sanctioned	Filled
Professors	-	-
Associate Professors	-	-
Asst. Professors	01	01

10. Faculty profile with name, qualification, designation, specialization, (D.Sc./D.Litt. /Ph.D. / M. Phil. etc.,)

Name	Qualification	Designation	Specialization	No. of Years of Experience	No. of Ph.D. Students guided for the last 4 years
Savita	M.A., B.Ed. N.E.T	Assistant Professor	INTERNATION AL ECONOMICS	3	NIL

11. List of senior visiting faculty -NO
12. Percentage of lectures delivered and practical classes handled(program wise) by temporary faculty -No
13. Student -Teacher Ratio (program wise) -1:150 in UG & 1:60 in P.G.
14. Number of academic support staff (technical) and administrative staff; sanctioned and filled- No
15. Qualifications of teaching faculty with DSc/ D.Litt/ Ph.D/ MPhil/PG. -P.G., N.E.T.
16. Number of faculty with ongoing projects from a) National b) International funding agencies and grants received -Proposal of Projects is sent to UGC for necessary action
17. Departmental projects funded by DST-FIST; UGC, DBT, ICSSR, etc. and total grants received- -No
18. Research Centre /facility recognized by the University -Nil
19. Publications:
- * a) Publication per faculty
One Paper is published in Indian Journal.
 - * Number of papers published in peer reviewed journals (national / international) by faculty and students -No
 - * Number of publications listed in International Database (For Eg: Web of Science, Scopus, Humanities International Complete, Dare Database - International Social Sciences Directory, EBSCO host, etc.) -No
 - * Monographs -No
 - * Chapter in Books -No
 - * Books Edited -No
 - * Books with ISBN/ISSN numbers with details of publishers -No

- * Citation Index -No
 - * SNIP -No
 - * SJR -No
 - * Impact factor -No
 - * h-index -No
20. Areas of consultancy and income generated -No
21. Faculty as members in
- a) National committees b) International Committees c) Editorial Boards....
 - (i) Membership of UP Govt. Colleges Academic Society.
 - (ii) Member of Uttar Pradesh and Ultra khand Indian Economic Association
22. Student projects
- a) Percentage of students who have done in-house projects including inter departmental/program -100 %
 - b) Percentage of students placed for projects in organizations outside the institution i.e.in Research laboratories/Industry/other agencies -No
23. Awards/ Recognitions received by faculty and students -No
24. List of eminent academicians and scientists/ visitors to the department
- -Proposed Visit of Dr. Mamta Bhatnagar
25. Seminars/ Conferences/Workshops organized & the source of funding
- a)National -No
 - b)International -No
26. Student profile program/course wise:

Name of the Course/program (refer question no. 4)	Applications received	Selected	Enrolled		Pass percentage
			*M	*F	
(U.G.) B.A.I	110	102	24	78	44
B.A.II	45	45	26	19	100
B.A.III	45	45	26	19	100
(P.G.) M.A.I	70	59	25	34	54
M.A.II	32	32	16	16	81

*M=Male F=Female

27. Diversity of Students

Name of the Course	% of students from the same state	% of students from other States	% of students from abroad
U.G.	100	X	X
P.G.	100	X	X
-	-	-	-
-	-	-	-

28. How many students have cleared national and state competitive examinations such as NET, SLET, GATE, Civil services, Defense services, etc. ? -10

29. Student progression

Student progression	Against % enrolled
UG to PG	90
PG to M.Phil.	no
PG to Ph.D.	no
Ph.D. to Post-Doctoral	no
Employed	
• Campus selection	no
• Other than campus recruitment	no
Entrepreneurship/Self-employment	25

30. Details of Infrastructural facilities

- a) Library -Yes
- b) Internet facilities for Staff & Students -Yes
- c) Class rooms with ICT facility -Yes
- d) Laboratories: - . -No

31. Number of students receiving financial assistance from college, university, government or other agencies:- -SC/ST, OBC, Minority and General Students receiving the scholarship from state govt.

32. Details on student enrichment programs (special lectures / workshops / seminar) with external experts :- -Special lecture proposed.
33. Teaching methods adopted to improve student learning: -Lectures, Student interaction & ICT
34. Participation in Institutional Social Responsibility (ISR) and Extension activities:-
- Participation in Polio Alleviation Program,
 - Motivation of voters to strengthen democracy
- Separates sheet attached herewith.
35. SWOC analysis of the department and Future plans
- S. Free and fair examination, Computer learning program
- W. Work overload
- O. To prepare the student for Job in banking area, Industrial Area & Self Employment.
- C. To motivate the student to fulfillment of state mission of the department
- Survey of Industry, Industrial Visit, Departmental competition.
 - Organizing tour for different industry to strengthen the knowledge of student in there subject

Evaluative Report of the Departments Sociology

The Self-evaluation of every department may be provided separately in about 3-4 pages, avoiding the repetition of the data.

1. Name of the department- Department of Sociology
2. Year of Establishment- 1988 (UG) & 1998 (P.G.)
3. Names of Programs / Courses offered (UG, PG, M.Phil., Ph.D., Integrated Masters; Integrated Ph.D., etc.) U.G. (B.A.I, B.A.II & B.A.III) & P.G. (M.A.I & M.A.II)
4. Names of Interdisciplinary courses and the departments/units involved **-No**
5. Annual/ semester/choice based credit system (program wise) Annual
6. Participation of the department in the courses offered by other departments **-No**
7. Courses in collaboration with other universities, industries, foreign institutions, etc. **-No**
8. Details of courses/programs discontinued (if any) with reasons **-No**
9. Number of Teaching posts

	sanctioned	Filled
Professors	-	-
Associate Professors	-	-
Asst. Professors	01	01

10. Faculty profile with name, qualification, designation, specialization, (D.Sc./D.Litt. /Ph.D. / M. Phil. etc.,)

Name	Qualification	Designation	Specialization	No. of Years of Experience	No. of Ph.D. Students guided for the last 4 years
Savita Rajan	M.A., B.Ed. N.E.T, J.R.F.	Assistant Professor	RURAL SOCIOLOGY	01	NIL

11. List of senior visiting faculty -NO
12. Percentage of lectures delivered and practical classes handled(program wise) by temporary faculty -No
13. Student -Teacher Ratio (program wise) -1:126 in UG & 1:60 in P.G.
14. Number of academic support staff (technical) and administrative staff; sanctioned and filled- No
15. Qualifications of teaching faculty with DSc/ D.Litt/ Ph.D/ MPhil/PG. -P.G., N.E.T., J.R.F
16. Number of faculty with ongoing projects from a) National b) International funding agencies and grants received - No
17. Departmental projects funded by DST-FIST; UGC, DBT, ICSSR, etc. and total grants received- -No
18. Research Centre /facility recognized by the University -Nil
19. Publications:
- * a) Publication per faculty
 - * Number of papers published in peer reviewed journals (national / international) by faculty and students -No
 - * Number of publications listed in International Database (For Eg: Web of Science, Scopus, Humanities International Complete, Dare Database - International Social Sciences Directory, EBSCO host, etc.) -No
 - * Monographs -No
 - * Chapter in Books -No
 - * Books Edited -No
 - * Books with ISBN/ISSN numbers with details of publishers -No
 - * Citation Index -No
 - * SNIP -No
 - * SJR -No
 - * Impact factor -No
 - * h-index -No
20. Areas of consultancy and income generated -No

21. Faculty as members in
- a) National committees b) International Committees c) Editorial Boards....
- (i) Membership of UP Govt. Colleges Academic Society.
22. Student projects
- a) Percentage of students who have done in-house projects including inter departmental/program -100 %
- b) Percentage of students placed for projects in organizations outside the institution i.e.in Research laboratories/Industry/other agencies -No
23. Awards/ Recognitions received by faculty and students -No
24. List of eminent academicians and scientists/ visitors to the department
- -Proposed Visit of Dr. Mamta Bhatnagar
25. Seminars/ Conferences/Workshops organized & the source of funding
- a)National -No
- b) International -No
26. Student profile program/course wise:

Name of the Course/program (refer question no. 4)	Applications received	Selected	Enrolled		Pass percentage
			*M	*F	
(U.G.) B.A.I	280	239	49	19	87
B.A.II	157	157	44	112	93
B.A.III	347	347	78	266	94
(P.G.) M.A.I	100	59	19	40	98
M.A.II	54	54	18	36	95

*M=Male F=Female

27. Diversity of Students

Name of the Course	% of students from the same state	% of students from other States	% of students from abroad
U.G.	100	X	X
P.G.	100	X	X
-	-	-	-
-	-	-	-

28. How many students have cleared national and state competitive examinations such as NET, SLET, GATE, Civil services, Defense services, etc. ? -10

29. Student progression

Student progression	Against % enrolled
UG to PG	100
PG to M.Phil.	x
PG to Ph.D.	x
Ph.D. to Post-Doctoral	x
Employed	
• Campus selection	x
• Other than campus recruitment	x
Entrepreneurship/Self-employment	25

30. Details of Infrastructural facilities

- a) Library -Yes
- b) Internet facilities for Staff & Students -Yes
- c) Class rooms with ICT facility -Yes
- d) Laboratories: - . -No

31. Number of students receiving financial assistance from college, university, government or other agencies:- -SC/ST, OBC, Minority and General Students receiving the scholarship from state govt.

32. Details on student enrichment programs (special lectures / workshops / seminar) with external experts :- -Special lecture proposed.

33. Teaching methods adopted to improve student learning: -Lectures, Student interaction & ICT

34. Participation in Institutional Social Responsibility (ISR) and Extension activities:-

- Participation in Polio Alleviation Program,
- Motivation of voters to strengthen democracy

Separates sheet attached herewith.

35. SWOC analysis of the department and Future plans

S. Free and fair examination, Computer learning program

W. Teacher student ratio is not sufficient

O. To prepare the student as a social Engineer, To prepare the student to job social welfare for the Betterment of the society

C. Motivate the student toward application of the subject.

1- Eradicate the social evil of society

2- Importance of Institution family, Joint family, Marriage etc.

➤ Social survey, visit and departmental competition.

➤ Organizing tour for different industry to strengthen the knowledge of student in there subject

Evaluative Report of the Departments Sanskrit

The Self-evaluation of every department may be provided separately in about 3-4 pages, avoiding the repetition of the data.

- Name of the department- Department of Sanskrit
1. Year of Establishment- 1988 (UG) & 1998 (P.G.)
 2. Names of Programs / Courses offered (UG, PG, M.Phil., Ph.D., Integrated Masters; Integrated Ph.D., etc.) U.G. (B.A.I, B.A.II & B.A.III)
 3. Names of Interdisciplinary courses and the departments/units involved -No
 4. Annual/ semester/choice based credit system (program wise) Annual
 5. Participation of the department in the courses offered by other departments -No
 6. Courses in collaboration with other universities, industries, foreign institutions, etc. -No
 7. Details of courses/programs discontinued (if any) with reasons -No
 8. Number of Teaching posts

	sanctioned	Filled
Professors	-	-
Associate Professors	-	-
Asst. Professors	01	01

9. Faculty profile with name, qualification, designation, specialization, (D.Sc./D.Litt. /Ph.D. / M. Phil. etc.,)

Name	Qualification	Designation	Specialization	No. of Years of Experience	No. of Ph.D. Students guided for the last 4 years
Kiran	M.A. SLET	Assistant Professor		01	NIL

10. List of senior visiting faculty -NO
11. Percentage of lectures delivered and practical classes handled(program wise) by temporary faculty -No
12. Student -Teacher Ratio (program wise) -100:1
13. Number of academic support staff (technical) and administrative staff; sanctioned and filled- No
14. Qualifications of teaching faculty with DSc/ D.Litt/ Ph.D/ MPhil/PG. -P.G., SLET
15. Number of faculty with ongoing projects from a) National b) International funding agencies and grants received -Project proposal in process
16. Departmental projects funded by DST-FIST; UGC, DBT, ICSSR, etc. and total grants received- -No
17. Research Centre /facility recognized by the University -Nil
18. Publications:
- * a) Publication per faculty
 - * Number of papers published in peer reviewed journals (national / international) by faculty and students -No
 - * Number of publications listed in International Database (For Eg: Web of Science, Scopus, Humanities International Complete, Dare Database - International Social Sciences Directory, EBSCO host, etc.) -No
 - * Monographs -No
 - * Chapter in Books -No
 - * Books Edited -No
 - * Books with ISBN/ISSN numbers with details of publishers -No
 - * Citation Index -No
 - * SNIP -No
 - * SJR -No
 - * Impact factor -No
 - * h-index -No
19. Areas of consultancy and income generated -No

20. Faculty as members in
- a) National committees b) International Committees c) Editorial Boards....
- (i) Membership of UP Govt. Colleges Academic Society.
21. Student projects
- a) Percentage of students who have done in-house projects including inter departmental/program -100 %
- b) Percentage of students placed for projects in organizations outside the institution i.e.in Research laboratories/Industry/other agencies -No
22. Awards/ Recognitions received by faculty and students -No
23. List of eminent academicians and scientists/ visitors to the department
- -Proposed Visit of Dr. Mamta Bhatnagar
24. Seminars/ Conferences/Workshops organized & the source of funding
- a)National -No
- b) International -No
25. Student profile program/course wise:

Name of the Course/program (refer question no. 4)	Applications received	Selected	Enrolled		Pass percentage
			*M	*F	
(U.G.) B.A.I	135	127	12	123	98
B.A.II	158	154	21	137	98
B.A.III	89	89	13	76	100

*M=Male F=Female

26. Diversity of Students

Name of the Course	% of students from the same state	% of students from other States	% of students from abroad
U.G.	100	X	X
-	-	-	-
-	-	-	-
-	-	-	-

27. How many students have cleared national and state competitive examinations such as NET, SLET, GATE, Civil services, Defense services, etc. ? -10

28. Student progression

Student progression	Against % enrolled
UG to PG	x
PG to M.Phil.	x
PG to Ph.D.	x
Ph.D. to Post-Doctoral	x
Employed	
• Campus selection	x
• Other than campus recruitment	x
Entrepreneurship/Self-employment	05

29. Details of Infrastructural facilities

- a) Library -Yes
- b) Internet facilities for Staff & Students -Yes
- c) Class rooms with ICT facility -Yes
- d) Laboratories: - . -No

30. Number of students receiving financial assistance from college, university, government or other agencies:- -SC/ST, OBC, Minority and General Students receiving the scholarship from state govt.

31. Details on student enrichment programs (special lectures / workshops / seminar) with external experts :- Special lecture proposed- Dr. Ramashankar Mishra
Head of Deptt.Lecture

32. Teaching methods adopted to improve student learning: -Lectures, Student interaction & ICT

33. Participation in Institutional Social Responsibility (ISR) and Extension activities:-

- Participation in Polio Alleviation Program,
- Motivation of voters to strengthen democracy

Separates sheet attached herewith.

34. SWOC analysis of the department and Future plans

S. Free and fair examination, Computer learning program

W. Work load

O. To prepare the student for job, civil services, teaching and self employment.

C. Motivate the student to fulfillment of stated mission.

➤ Visit the library,

➤ Model competition, essay writing,

➤ To knowledge about ancient poets and writers of the Sanskrit language.

Evaluative Report of the Departments **Commerce**

The Self-evaluation of every department may be provided separately in about 3-4 pages, avoiding the repetition of the data.

1. Name of the department- Department of Commerce
2. Year of Establishment- 1988 (UG)
3. Names of Programs / Courses offered (UG, PG, M.Phil., Ph.D., Integrated Masters; Integrated Ph.D., etc.) U.G. (B. Com. I, B. Com. II & B. Com.III)
4. Names of Interdisciplinary courses and the departments/units involved -No
5. Annual/ semester/choice based credit system (program wise) -
Annual
6. Participation of the department in the courses offered by other departments -No
7. Courses in collaboration with other universities, industries, foreign institutions, etc. -No
8. Details of courses/programs discontinued (if any) with reasons -No
9. Number of Teaching posts

	sanctioned	Filled
Professors	-	-
Associate Professors	01	01
Asst. Professors	-	-

10. Faculty profile with name, qualification, designation, specialization, (D.Sc./D.Litt. /Ph.D. / M. Phil. etc.,)

Name	Qualification	Designation	Specialization	No. of Years of Experience	No. of Ph.D. Students guided for the last 4 years
Dr. S.N. Rai	M.Com., Ph.D	Associate Professor	MARKETING	16	NIL

11. List of senior visiting faculty -NO
12. Percentage of lectures delivered and practical classes handled(program wise) by temporary faculty -No
13. Student -Teacher Ratio (program wise) -1:60
14. Number of academic support staff (technical) and administrative staff; sanctioned and Filled- No
15. Qualifications of teaching faculty with DSc/ D.Litt/ Ph.D/ MPhil/PG. -P.G. ,Ph. D.
16. Number of faculty with ongoing projects from a) National b) International funding agencies and grants received -Proposal of Projects is sent to UGC for necessary action
17. Departmental projects funded by DST-FIST; UGC, DBT, ICSSR, etc. and total grants received- -No
18. Research Centre /facility recognized by the University -Nil
19. Publications:

* a) Publication per faculty

1. “Bharat Mein Vinayamit Mandiyon Ka Vikas”

[Agriculture Marketing-July-September 1993 Vol. XXXVI , No.2 I.S.S.N. 0002-1555]

Shri Bhagvan Rai and Sadanand Rai

2. “Uttar Pradesh Mein Niyamit Bajar Vayastha ki Pragati”

[Praband, Oct.1993 March 1994]

Dr. Vishambhar Jha and Dr.Sadanand Rai

3. “Uttar Pradesh Mein Krishi Viparan Vayawastha Ki Samasya”

[Prabhandh, April-Sept.95]

Dr. Sadanand Rai

4. “Panchvarshiya Yojanayen and Krishi Ek Mulyankan”

[Prabandh, April-December-1999]

Dr. Sadanand Rai

5. “Vikraya Ke Bad Seva”

[Proceedings of First Course in Commerce,September 4- 24, 2001.

UGC-Academic Staff College Banaras Hindu University Varanasi]

Dr. Sadanand Rai

6. “Prabhav Poorna Sampreshan”

[Proceeding of Second Refresher Course In Commerce, February 10 -

March-1, 2004, UGC-Academic Staff College Banaras Hindu University Varanasi]

Dr. Sadanand Rai

7. “Bharat Mein Krishi Viparan Vayawastha: Uttar Pradesh Mein Krishi Viparan Vayawastha Ke Vishesh Sandharbh Mein”

[Prabhand, January-June 2006]

Dr. Sadanand Rai

8. “Uttar Pradesh Mein Krishi Utpaad Ki Agmark Vayawastha”

[Prabhand, January-June 2007]

Dr. Sadanand Rai

- * Number of papers published in peer reviewed journals (national / international) by faculty and students -No
- * Number of publications listed in International Database (For Eg: Web of Science, Scopus, Humanities International Complete, Dare Database - International Social Sciences Directory, EBSCO host, etc.) -No
- * Monographs -No
- * Chapter in Books -No
- * Books Edited -No
- * Books with ISBN/ISSN numbers with details of publishers -No
- * Citation Index -No
- * SNIP -No
- * SJR -No

- * Impact factor -No
- * h-index -No
20. Areas of consultancy and income generated -No
21. Faculty as members in
- a) National committees b) International Committees c) Editorial Boards....
- (i) Membership of UP Govt. Colleges Academic Society.
22. Student projects
- a) Percentage of students who have done in-house projects including inter departmental/program -100 %
- b) Percentage of students placed for projects in organizations outside the institution i.e.in Research laboratories/Industry/other agencies -No
23. Awards/ Recognitions received by faculty and students -No
24. List of eminent academicians and scientists/ visitors to the department -No
25. Seminars/ Conferences/Workshops organized & the source of funding
- a)National -No
- b) International -No
26. Student profile program/course wise:

Name of the Course/program (refer question no. 4)	Applications received	Selected	Enrolled		Pass percentage
			*M	*F	
B.Com.I	80	54	46	8	65
B.Com.II	47	47	44	3	64
B.Com.III	32	32	30	2	81

*M=Male F=Female

27. Diversity of Students

Name of the Course	% of students from the same state	% of students from other States	% of students from abroad
UG	100	X	X
-	-	-	-
-	-	-	-
-	-	-	-

28. How many students have cleared national and state competitive examinations such as NET, SLET, GATE, Civil services, Defense services, etc. ? -10

29. student progression

Student progression	Against % enrolled
UG to PG	no
PG to M. Phil.	no
PG to Ph.D.	no
Ph.D. to Post-Doctoral	no
Employed	
• Campus selection	no
• Other than campus recruitment	no
Entrepreneurship/Self-employment	35

30. Details of Infrastructural facilities

- a) Library -Yes
- b) Internet facilities for Staff & Students -Yes
- c) Class rooms with ICT facility -Yes
- d) Laboratories: - . -No

31. Number of students receiving financial assistance from college, university, government or other agencies:- -SC/ST, OBC, Minority and General Students receiving the scholarship from state govt.

32. Details on student enrichment programs (special lectures / workshops / seminar) with external experts: - -Special lecture proposed.
33. Teaching methods adopted to improve student learning: -Lectures, Student interaction & ICT
34. Participation in Institutional Social Responsibility (ISR) and Extension activities:-
- Participation in Polio Alleviation Program,
 - Motivation of voters to strengthen democracy
- Separates sheet attached herewith.
35. SWOC analysis of the department and Future plans
- S. Free and fair examination, Computer learning program
- W. Non availability of P.G. in Commerce
- O. Job opportunities available in different fields like banking, Industry Sector.
- C. To prepare the students of the college with matching of global standard
- Development of Departmental of Library.
 - Organizing tour for different industry to strengthen the knowledge of student in there subject

Evaluative Report of the Departments

Commerce

The Self-evaluation of every department may be provided separately in about 3-4 pages, avoiding the repetition of the data.

1. Name of the department- Department of Commerce
2. Year of Establishment- 1988 (UG)
3. Names of Programs / Courses offered (UG, PG, M. Phil., Ph.D., Integrated Masters; Integrated Ph.D., etc.) U.G. (B. Com. I, B. Com. II & B. Com.III)
4. Names of Interdisciplinary courses and the departments/units involved -No
5. Annual/ semester/choice based credit system (program wise) Annual
6. Participation of the department in the courses offered by other departments -No
7. Courses in collaboration with other universities, industries, foreign institutions, etc. -No
8. Details of courses/programs discontinued (if any) with reasons -No
9. Number of Teaching posts

	sanctioned	Filled
Professors	-	-
Associate Professors	-	-
Asst. Professors	01	01

10. Faculty profile with name, qualification, designation, specialization, (D.Sc./D.Litt. /Ph.D. / M. Phil. etc.,)

Name	Qualification	Designation	Specialization	No. of Years of Experience	No. of Ph.D. Students guided for the last 4 years
Dr. V. K. Mishra	M.Com., Ph. D	Assistant Professor	APPLIED ECONOMICS	16	NIL

11. List of senior visiting faculty -NO
12. Percentage of lectures delivered and practical classes handled(program wise) by temporary faculty -No
13. Student -Teacher Ratio (program wise) -1:60
14. Number of academic support staff (technical) and administrative staff; sanctioned and filled- No
15. Qualifications of teaching faculty with D.Sc./ D. Lit/ Ph. D/ M. Phil./PG. -P.G. ,Ph. D.
16. Number of faculty with ongoing projects from a) National b) International funding agencies and grants received -Proposal of Projects is sent to UGC for necessary action
17. Departmental projects funded by DST-FIST; UGC, DBT, ICSSR, etc. and total grants received- -No
18. Research Centre /facility recognized by the University -Nil
19. Publications:
- * a) Publication per faculty
 1. “An Analytical Study of the Performance of Regional Rural Banks”
Uttar Pradesh Rajkiya Mahavidyalya Academic Society 11th Convention, 28-29th January, 2006.
V.K.Mishra
 - * Number of papers published in peer reviewed journals (national / international) by faculty and students -No
 - * Number of publications listed in International Database (For e.g.: Web of Science, Scopus, Humanities International Complete, Dare Database - International Social Sciences Directory, EBSCO host, etc.) -No
 - * Monographs -No
 - * Chapter in Books -No

* Books Edited	-No
* Books with ISBN/ISSN numbers with details of publishers	
* Citation Index	-No
* SNIP	-No
* SJR	-No
* Impact factor	-No
* h-index	-No
20. Areas of consultancy and income generated	-No
21. Faculty as members in	
a) National committees b) International Committees c) Editorial Boards....	
(i) Membership of UP Govt. Colleges Academic Society.	
(ii) Membership of Indian Economical Association	
22. Student projects	
a) Percentage of students who have done in-house projects including inter departmental/program	-100 %
b) Percentage of students placed for projects in organizations outside the institution i.e.in Research laboratories/Industry/other agencies	-No
23. Awards/ Recognitions received by faculty and students	
➤ Utkrisht Shiksha Sewa samman	
24. List of eminent academicians and scientists/ visitors to the department	-No
25. Seminars/ Conferences/Workshops organized & the source of funding	
a)National	-No
b)International	-No

26. Student profile program/course wise:

Name of the Course/program (refer question no. 4)	Applications received	Selected	Enrolled		Pass percentage
			*M	*F	
B. Com.I	80	54	46	8	65
B. Com.II	47	47	44	3	64
B. Com.III	32	32	30	2	81

*M=Male F=Female

27. Diversity of Students

Name of the Course	% of students from the same state	% of students from other States	% of students from abroad
UG	100	X	X
-	-	-	-
-	-	-	-
-	-	-	-

28. How many students have cleared national and state competitive examinations such as NET, SLET, GATE, Civil services, Defense services, etc. ? -10

29. Student progression

Student progression	Against % enrolled
UG to PG	x
PG to M.Phil.	x
PG to Ph.D.	x
Ph.D. to Post-Doctoral	x
Employed	
• Campus selection	x
• Other than campus recruitment	x
Entrepreneurship/Self-employment	35

30. Details of Infrastructural facilities

- | | |
|---|------|
| a) Library | -Yes |
| b) Internet facilities for Staff & Students | -Yes |
| c) Class rooms with ICT facility | -Yes |
| d) Laboratories: - | -No |

31. Number of students receiving financial assistance from college, university, government or other agencies:- -SC/ST, OBC, Minority and General Students receiving the scholarship from state govt.

32. Details on student enrichment programs (special lectures / workshops / seminar) with external experts :- -Special lecture proposed.

33. Teaching methods adopted to improve student learning: -Lectures, Student interaction & ICT

34. Participation in Institutional Social Responsibility (ISR) and Extension activities:-

- Participation in Polio Alleviation Program,
- Motivation of voters to strengthen democracy

Separates sheet attached herewith.

35. SWOC analysis of the department and Future plans

S. Free and fair examination, Computer learning program

W. Non availability of P.G. in Commerce

O. Job opportunities available in different fields like banking, Industry Sector.

C. To prepare the students of the college with matching of global standard

➤ Development of Departmental of Library.

➤ Organizing tour for different industry to strengthen the knowledge of student in there subject

Format for Presentation of Practice

1. Title of the Practice

This title should capture the keywords that describe the Practice.

- Interactive Learning and ICT (Information and Communication Technology)
- Creativity and Scientific Temper.

2. Goal

Describe the aim of the practice followed by the institution. Brief the underlying principles or concepts in about 100 words.

- The Government of U.P. has established the Government College to provide need based and skill oriented quality higher education to students from remote backward areas
- Inculcating best knowledge in students and there overall personality development.
- To achieve the goal by excellence in teaching, learning and research.
- To make learning more student centric.
- To think logically, analytically and creativity.
- To prepare the students responsive to need of society.
- To prepare the students for the participation in socio political,-cultural development of society with a secular spirit.
- To give exposure of advanced level of knowledge and skill through expert teachers, seminar, workshops etc.
- To prepare for students successful careers and life long learning in a multicultural society.
- To prepare the students for research to make the academic programs relevant to the changing globalizing time.

3. The Context

Describe any particular contextual feature or challenging issues that have had to be addressed in designing and implementing the Practice in about 150 words.

- We have implemented these practices in our institution just to seek the global standard because as it is a remote backward area.
- The institution lays great emphasis on overall personality development of the students of rural area and without implementing these practices it is impossible to achieve the goal.
- Creativity and scientific temper is the need of the hour because without it a student cannot walk over a step in the field of research and industrialization.
- Implementation of these practices provide major benefit to girls students (65 %) as these practices are keys to success so this is a step toward women empowerment.
- Interaction with alumni and parents motivates the institution for quality enhancement which can only be achieved by implementing the practices so this is also one of the major contextual features.

4. The Practice

Describe the Practice and its implementation. Include anything about this practice that may be unique in the Indian higher education. Please also identify constraints or limitations, if any, in about 400 words.

Faculty member used the following best practices for teaching-

- We engage the students in active learning experiences to provide and receive regular time bound and specific faculty wise feedback through IQAC
- We recognize and stress the student's mental status and developmental level.
- We teach them to apply their knowledge in their practical life.
- We try to create opportunity for students and faculty interaction through group discussion, Seminars, extension lectures, and presentations.

- We engage our students with high level of involvement in their studies with other students and the faculty.
- We implement the regular and thoughtful and periodic assessment of students.

ICT is the most important tool for effective teaching. It helps to gather, connect and analyses the data about teaching, learning and enables us to move accurately diagnose students' need and evaluate the progress. It adds quality in teaching learning and evaluation. The best cognitive understanding and practice can be captured and communicated by ICT and quality of learning. By using ITC teacher can improve his/her knowledge and may tailor learning meet to particular needs of student at every step of his/her education.

ICT is a strong tool to converge many technologies for e.g., medical technology is converging with educational technology. Lectures may be made more effective and understandable through flowchart and box diagram by using ICT.

Alignment is an emerging concept facilitated by ICT teaching learning process can be effective and helpful to students by well defined educational objective, if the standard objective, teaching curriculum, resource technology used and assessment are aligned. The content and method of assessment should be aligned to measure the standard of an objective.

5. Evidence of Success

Provide evidence of success such as performance against targets and benchmarks and review results. What do these results indicate? Describe in about 200 words.

- Ragging free campus: No untoward incidence toward indiscipline.
- Lush Green campus: The plantation program is done each and every year.
- Aesthetic and cultural atmosphere: Programs of moral and ethical values by celebrating the memorial days, National festivals and organization of cultural programs.

- Transparent working: Admission, strictly on merit basis with adopting reservation rules. Copying free examination centre.
- Distinguished and committed faculty: All the faculty members are well qualified & selected by U.P.P.S.C (Uttar Pradesh Public Service Commission)
- The college alumni hold key post in government and industry.
- Prestigious High Quality Educational Institute: Within hundred kilometers of area none such institute which in imparting high quality higher education.

6. Problems Encountered and Resources Required

Please identify the problems encountered and resources required to implement the practice in about 150 words.

- 1- Single faculty member of department in all streams. (B.A., B.Sc. & B.Com.)

Solution: Extra classes

- 2- Scarcity of electricity also constraints our hand in smooth functioning of practices

Solution: Generator and Inverter

- 3- Pressure on admission due to non –availability of such non profit Govt. educational institute within hundred kilometers area.

Solution: The Govt. increases the seats according to the demand.

- 4- Due to Government institution transfer of librarian put a pressure on rapid functioning of library which hinders the implementation of practices of interactive learning?

Solution: The head of the institution had appointed a senior faculty member to manage the library work.

7. Notes (Optional)

Any other information that may be relevant and important to the reader for adopting/ implementing the Best Practice in their institution about 150 words.

The boundaries between teacher and student have least meaning with interactive learning. Student and teacher rely on each other to access source of knowledge and share their information for expansion of knowledge. In the present scenario of higher education requires following changes-

1-It should be multi-dimensional from linear to hyper media.

2- It should follow from instruction to construction and discovery.

3- It should be indicated to teacher-centred and should progress toward learner- centred.

4- It should be started from observing material and should progress toward learning how to navigate and how to learn.

5- Learning should be joyful and fun.

Lastly teacher should be as transmitter of knowledge in the beginning and fascinator in the in the way of teaching.

8. Contact Details

Name of the Principal: Dr. Rajeev Dhasamana

Name of the Institution: Indira Gandhi Govt. P. G. College, Bangarmau (Unnao) U.P.

City: Bangarmau

Pin Code: 209868

Accredited Status: Cycle I

Work Phone : 05144-250047

Fax: 05144-250288

Website: iggpgcbmu.org

E-mail: Rajeevdhasmanalko@gmail.com

Mobile: 9415952203

PART-II

Post-accreditation Initiatives

If the college has already undergone the accreditation process by NAAC, please highlight the significant quality sustenance and enhancement measures undertaken during the last four years. The narrative may not exceed five pages.

Executive Summary

The college has been established in the year 1988 with an aim to provide qualitative higher education and to foster creativity analytical ability through overall personality development of students of Bangarmau, a remote backward area and also neighboring areas.

Initially due to lack of building, the college was started in the building of Subhash Inter College, Bangarmau, Unnao, and after six months the college was shifted to its own building. The college is situated at Kanpur-Hardoi State highway. It has lush-green campus with 12 acre area. Firstly, Commerce and Art faculties were started in the year 1988 further, in 1996, Science faculty was started. The college got the recommendation for starting Post Graduate classes in three subjects i.e. Hindi, Sociology and Economics.

The college is affiliated with Chhatrapati Shahu Ji Maharaj, (CSJM) University Kanpur, (U.P.) the largest affiliating University of India. The college is included under section 2-f and 12-B of the UGC Act 1956.

The college possesses

- ❖ Well equipped four laboratories i.e. Physics, Chemistry, Zoology and Botany.
- ❖ Lecture rooms of capacity of 80 students for teaching and learning.
- ❖ Basic infra-structural amenities like Generator, Water Cooler with Aqua-guard, Photo Stat Machine, Fax Machine, Refrigerator, and Computer Lab with Broad Band facilities.
- ❖ Rich Library consisting of text books, reference books, magazines, Journals, News Papers and with computerized accession.

- ❖ Principal's residence, Hostel facility for boys specially for backward classes and canteen to provide refreshments.
- ❖ Distinguished, highly qualified and committed faculty to serve the diverse section of the society from remote and backward areas of Bangarmau. The faculty contributes to various activities of personality development and skill development of the students.
- ❖ Transparent and time bound admission process of Under Graduate and Post Graduate is strictly on merit basis reservation for all categories is provided as per U.P Government Rules.

The college is unique and based on high quality education and research. It aims to inculcate a sense of hard work, commitment, devotion, discipline and nationalism in an aesthetic and cultural atmosphere matching global standard. A regular feed back from students about their studies, Institutional atmosphere, ragging and difficulties is taken. This feed back is communicated to IQAC of the college which after evaluation it gives remedial measures to be implemented by the Principal. Our faculty members are in regular touch with all students including alumni association.

This entire Endeavour helps us to achieve the vision, mission and objectives of the college.

Principal

Declaration by the Head of the Institution

I certify that the data included in the Self Study Report (SSR) are true to the best of my knowledge.

This SSR is prepared by the institution after internal discussions and no part thereof has been outsourced.

I am aware that the Peer Team will validate the information provided in this SSR during the Peer Team visit.

Place

Date

Principal

Dr. Rajeev Dhasmana



राष्ट्रीय मूल्यांकन एवं प्रत्यायन परिषद

विश्वविद्यालय अनुदान आयोग का स्वायत्त संस्थान

NATIONAL ASSESSMENT AND ACCREDITATION COUNCIL
An Autonomous Institution of the University Grants Commission

Dr. M.S. Shyamasundar
Deputy Adviser

NAAC/MSS-NR/IEQA-17(E)/ID-15403/2011-12/47

29 March, 2012

The Principal

Indira Gandhi Govt.P.G.College
Bangarmau-241501, Dist.Unnao,
Uttar Pradesh

Sir/Madam,

Subject: Declaration of IEQA status – reg.

Greetings from NAAC.

This has reference to your application for **Institutional Eligibility for Quality Assessment (IEQA)**. CRIEQA committee has reviewed your application in the recently held meeting at NAAC. As per the committee's outcome, I am delighted to inform you that your institution has **EARNED** the "Institutional Eligibility for Quality Assessment (IEQA)" status of NAAC.

You may prepare the **Self-study Report (SSR)** based on the "Manual for Self-study for Affiliated/Constituent Colleges" and the same may be submitted in **five** hard bound copies with **one** copy of the same (word format) in CD and/or in pendrive to NAAC within six months from this declaration. Your institution has to submit SSR/SAR based on the revised manual which would be launched by NAAC during April/May, 2012.

For any further assistance in this matter kindly feel free to contact us or visit our website for latest updates.

Kindly acknowledge the receipt of the letter.

Thanking you,
With best wishes
Yours sincerely,

(M.S. Shyamasundar)

Dr. Anil Kumar
Do Necessary action
Done
11-04-12

पिए ओए वाक्स नं. 1075, नागरभावी, बेंगलूर - 560 072, भारत P.O.Box No. 1075, Nagarbhavi, Bangalore - 560 072, INDIA
दूरभाषा Phone : +91-80-23005119 (D), 23210261,62,63,64,65, Fax : +91-80-23210270 (R) 080-26760873
ई-मेल : e-mail : shyam_naac@yahoo.co.in वैबसाइट Website : www.naac.gov.in

30

UNIVERSITY GRANTS COMMISSION
RANAJUR SHAH ZAFARIBAG
NEW DELHI-110002.

No. F. 8-70/93 (CPP-I)

March, 1994

The Registrar
Kanpur University
Kalyanpur,
Kanpur-24.

19 MAR 1994

Sub: -List of Colleges prepared under Section 2 (f) of the
UGC Act, 1956-Inclusion of New Colleges.

Sir,
I am directed to refer to your letter No. KU/Vikas/CDC/
429/93 dated 16th September, 1993 on the above subject and
to say that the name of the following college has been
included in the above list under Govt. Colleges teaching
upto Bachelor's Degree :-

<u>Name of the college</u>	<u>Year of Estt.</u>	<u>Remarks</u>
✓ Indira Gandhi Govt. Degree College Bangumau (Distt. Unnao-UP) Prof. L.N. Varshney	1985	The College is eligible to receive central assistance in terms of the rules framed under Section <u>12-B</u> of the UGC Act, 1956.

शुभानु
 26/3/94
 Copy forwarded to :-
 1. The Principal, Indira Gandhi Govt. Degree College,
 Bangumau, Distt. Unnao-U P .
 2. The Secretary, Govt. of India, Ministry of Human
 Resource Development (Deptt. of Education,) T-14
 Section) New Delhi.
 3. All Officers/Sections in the UGC Office.
 4. S.O., FD-III/CD-III UGC Office.
 5. Incharge Computer Cell UGC.
 6. Guard file.
 30.3.94

Yours faithfully,
R. L. GNDHI
(R L GNDHI)
UNDER SECRETARY

D D MEHTA
(D D MEHTA)
SECTION OFFICER

(28)

संख्या-ई-2951/जी०एस०
लखानऊ-227132 दिनांक मई 19, 1993

प्रेषक, श्री राज्यपाल/कुलाधिपति के अपर परामर्शी, उत्तर प्रदेश

सेवा में,
कुल सचिव,
कानपुर विश्वविद्यालय,
कानपुर ।

परामर्शी के
19/5/93

महोदय,

आपके पत्र संख्या का०वि०/सम्ब०/5655-58/92 दिनांक 22-9-92 के संदर्भ में मुझे आपसे यह कहने का निदेश हुआ है कि कुलाधिपति महोदय ने उत्तर प्रदेश राज्य विश्वविद्यालय अधिनियम, 1973 की धारा-37(2) के अधीन इंदिरा गांधी राजकीय महाविद्यालय, बांगरमऊ {उन्नाव} को स्नातक स्तर पर हिन्दी भाषा, अंग्रेजी भाषा, हिन्दी, अंग्रेजी, संस्कृत, अर्थशास्त्र, इतिहास तथा समाजशास्त्र तथा बी०काम०विषयों में दिनांक 1-7-91 से स्थाई सम्बद्धता की स्वीकृति सहर्ष प्रदान कर दी है ।

भावदीय,

चन्द्र भूषण वाण्डे
श्री राज्यपाल/कुलाधिपति के विधि परामर्शी

शिक्षा अनुभाग-17 की पत्रावली हेतु

संख्या-1872/15/17/93-74/29/91 : तददिनांक

प्रतिलिपि निम्नांकित को सूचनाार्थ एवं आवश्यक कार्यवाही हेतु प्रेषित :-

1. शिक्षा निदेशक {उ०शि०} उ०प्र० इलाहाबाद ।
2. प्राचार्य, राजकीय महाविद्यालय बांगरमऊ {उन्नाव} ।
3. संयुक्त शिक्षा निदेशक {उ०शि०} उ०प्र० इलाहाबाद ।

10.6.93
{एस०एल०केसरवानी}
विशेष सचिव ।

१०

प्रतिलिपि पत्र संख्या-800/सत्तर-5-2007-40(35)97 दिनांक 11.07.2007 द्वारा अनुसचिव उच्च शिक्षा अनुभाग-6, उत्तर प्रदेश शासन, लखनऊ सम्बोधित कुलसचिव, छत्रपति शाहू जी महाराज विश्वविद्यालय, कानपुर ।

आपके पत्रांक सी0एस0जे0एम0वि0वि0/सम्ब./748/2007 दिनांक 18.05.2007 के संदर्भ में मुझे आपसे यह कहने का निर्देश हुआ है कि कि उ0प्र0राज्य विश्वविद्यालय अधिनियम 1973(यथा संशोधित उत्तर प्रदेश राज्य विश्वविद्यालय संशोधन अध्यादेश, 2007) की धारा-37(2) के अधीन श्री राज्यपाल इन्दिरागांधी राजकीय स्नातकोत्तर महाविद्यालय, बांगरमऊ, उन्नाव को स्नातक स्तर पर विज्ञान संकाय के अन्तर्गत भौतिक विज्ञान, रसायन विज्ञान, गणित, जन्तु विज्ञान, वनस्पति विज्ञान विषयों में दिनांक 01.07.2007 से सम्बद्धता की स्वीकृति सहर्ष प्रदान करते हैं:-

2. विश्वविद्यालय की परिनियमावली/अध्यादेश में वर्णित तथा शासन एवं विश्वविद्यालय द्वारा निर्धारित शर्तों एवं मानकों की पूर्णता तथा उनकी निरन्तरता को महाविद्यालय के प्राचार्य/निदेशक द्वारा सुनिश्चित किया जाएगा ।

छत्रपति शाहू जी महाराज विश्वविद्यालय, कानपुर

सी0एस0जे0एम0वि0वि0/सम्ब0/ 1647 /2007

दिनांक 18/07/07

प्रतिलिपि निम्नलिखित को सूचनार्थ एवं आवश्यक कार्यावाही हेतु प्रेषित :-

1. प्राचार्य, इन्दिरागांधी राजकीय स्नातकोत्तर महाविद्यालय, बांगरमऊ, उन्नाव को इस आशय से प्रेषित है कि महामहिम कुलाधिपति जी के उपरोक्त निर्देशों का अनुपालन करना सुनिश्चित करें । माननीय कुलपति जी के आदेशानुसार यह भी सूचित करना है कि प्राचार्य, शिक्षकों का ज्वानिंग पत्र (छायाचित्र सहित) विश्वविद्यालय को उपलब्ध कराया जाना और महामहिम कुलाधिपति महोदय के सम्बद्धता पत्र में इंगित शर्तों की पूर्ति/निरन्तरता बनाये रखना सुनिश्चित कराया जाए ।
2. उप कुलसचिव(परीक्षा) सी0एस0जे0एम0वि0वि0/सम्ब0/748/2007 विश्वविद्यालय, कानपुर ।
3. सिस्टम मैनेजर, सी0एस0जे0एम0वि0वि0/सम्ब0/748/2007 विश्वविद्यालय, कानपुर ।
4. इंचार्ज, ई0डी0पी0सेन्टर, सी0एस0जे0एम0वि0वि0/सम्ब0/748/2007 विश्वविद्यालय, कानपुर ।

(महेश चन्द्र)
कुलसचिव

प्रतिलिपि पत्र संख्या-ई.सं.2623/जी0एस0 दिनांक 9.11.2005 द्वारा महामहिम कुलाधिपति जी के विशेष सचिव, राज्यपाल सचिवालय, राजभवन, लखनऊ सम्बोधित कुलसचिव, छत्रपति शाहू जी महाराज विश्वविद्यालय, कानपुर ।

आपके पत्र संख्या सी0एस0जे0एम0वि0वि0/सम्ब0/4086/2004 दिनांक 01.9.2005 के संदर्भ में मुझे आपसे यह कहने का निर्देश हुआ है कि महामहिम कुलाधिपति महोदय ने उ0प्र0राज्य विश्वविद्यालय अधिनियम 1973 की धारा-37(2) के अधीन इन्दिरागांधी राजकीय महाविद्यालय, बांगरमऊ, उन्नाव को परास्नातक स्तर पर कला संकाय के अंतर्गत हिन्दी, अर्थशास्त्र, समाजशास्त्र विषयों में निम्नलिखित शर्तों के अधीन दिनांक 1.7.2005 से सम्बद्धता की स्वीकृति सहर्ष प्रदान कर दी है:-

1. यदि महाविद्यालय द्वारा विश्वविद्यालय की परिनियमावली में वर्णित तथा शासन एवं विश्वविद्यालय द्वारा निर्धारित शर्तों एवं मानकों की पूर्णता एवं उनकी निरन्तरता को सुनिश्चित नहीं किया जायेगा तो उ0प्र0 राज्य विश्वविद्यालय अधिनियम 1973 के सुसंगत प्राविधानों के अंतर्गत महाविद्यालय को प्रदान की गई सम्बद्धता वापस लिये जाने की कार्यवाही नियमानुसार की जायेगी ।

छत्रपति शाहू जी महाराज विश्वविद्यालय, कानपुर

सी0एस0जे0एम0वि0वि0/सम्ब0/ 5300 /2005

दिनांक 28-11-05

प्रतिलिपि निम्नलिखित को सूचनार्थ एवं आवश्यक कार्यावाही हेतु प्रेषित :-

1. प्राचार्य, इन्दिरागांधी राजकीय महाविद्यालय, बांगरमऊ, उन्नाव को इस आशय से प्रेषित है कि महामहिम कुलाधिपति महोदय के उपरोक्त निर्देशों का अनुपालन करना सुनिश्चित करें ।
2. सिस्टम मैनेजर, सी0एस0जे0एम0वि0वि0/सम्ब0/4086/2004, कानपुर ।
3. इंचार्ज, ई0डी0पी0सेन्टर, सी0एस0जे0एम0वि0वि0/सम्ब0/4086/2004, कानपुर ।



(महेश चन्द्र)
कुलसचिव

कार्यालय परगनाधिकारी सफीपुर, उन्नाव ।

संख्या-मेमो/डि०का०बॉगरमऊ/आशु-94-95 दिनांक अगस्त 5, 1994

प्रमाणपत्र
=====

प्राचार्य, राजकीय महाविद्यालय बॉगरमऊ जनपद उन्नाव के आ०
शा०पत्रांक 105/94-95 दि०8-7-94 के अनुक्रम में प्रमाणित किया जाता
है कि इन्दिरा गाँधी राजकीय महाविद्यालय बॉगरमऊ एक सुदूरवर्ती
एवं पिछड़े क्षेत्र में स्थित है ।

परगनाधिकारी सफीपुर,
उन्नाव।

Principal